

DR-8-2015

File No. 15090009Fee: 50.00Check or Receipt#: CC#1206

Supersedes File No.(s) _____ or none _____

Initials: SW

Scheduled Public Hearing Date: _____

Date Received 9/10/15

APPLICATION FOR CERTIFICATE OF APPROPRIATENESS DESIGN REVIEW

CITY OF GAHANNA PLANNING COMMISSION

***Required Information**

*Site Address 505 MORRISON RD GAHANNA OH 43230

*Parcel ID# 025-001131-00 *Zoning District PUD IN GAHANNA

*Business Name KINDRED ARTISAN ALES TASTING ROOM *Contact MAX: 614-772-6430

*Business Owner Name KINDRED ALES LLC *Phone# _____

*Business Address 505 MORRISON RD GAHANNA OH 43230

*Applicant Name STEVE KIRK *Applicant Email SKIRK@COMPTONLLC.COM

*Applicant Full Address 2323 W. 5TH AVE SUITE 215 COLUMBUS OH 43204

*Applicant Phone# 614-565-6610 Applicant Fax# _____

*Designer/ Architect/ Engineer WSA STUDIO

*Address 982 S. FRONT STREET *Phone 614-874-1633

*City/ State/ Zip COLUMBUS, OH 43206 Fax _____

*D/A/E Representative FRANK WEAYER Title STUDIO LEADER

*Design Review of: Site Plan _____ Landscaping _____ Building Design ☒ Signage ☒ Other _____

*Special Information Regarding the Property and its Proposed Use: _____

Submission Requirements

- (1) Applicant is required to complete the checklist on the following pages.
- (2) Fee: \$50.00 for review plus \$.01 per square foot.
- (3) Eleven copies of plans: Two (2) copies of 24x36 (folded, not rolled, to 8 1/2 x 11 inch size prior to submission) & nine (9) 11x17.
- (4) ~~Submit one (1) reduced drawing suitable to an 8 1/2 x 11 inch size.~~
- (5) Submit one (1) color rendering of the project in plan/ perspective/ or elevation, mounted on 18 x 24 inch size foam core, gator board or other acceptable material.
- (6) Submit a detailed list of materials.

*Note: This application will not officially be accepted until all items listed above have been received.

**Note: Planning Commission members and/or City Staff may visit the property prior to the hearing to review the application.

At Kirk
*Applicant's Signature

9/9/2015
*Date

APPROVAL

In accordance with Sections 1197.05 of the Codified Ordinances of Gahanna, this certifies that this project, as stated above, has been approved by the Gahanna Planning Commission on _____. The applicant shall comply with any conditions approved by the Commission, and shall comply with all building and zoning regulations now in force.

Conditions: _____

Planning & Zoning Administrator

Date

Note: All correspondence will be to applicant above unless otherwise stated.

Revised April 2012

RECEIVED
SEP 10 2015

BY: SW

SUBMITTAL REQUIREMENTS

	Applicant Or Agent	Planning & Zoning Administrator
I. GENERAL REQUIREMENTS		
A. All exhibits required for the permanent file (noted in the following paragraphs) must be able to be reduced to 8 1/2 x 11 by folding, photo reduction, etc. (ALL 24x36 PLANS ARE TO BE FOLDED BY APPLICANT PRIOR TO SUBMISSION.) While large mounting boards, material samples, or other exhibits not meeting this criteria maybe used for Planning Commission presentation, the Commission does appreciate the use of the audio visual system whenever possible.	A. _____	_____ ✓
B. Eleven ^{THREE} (two 24x 36, nine ⁴ 11x 17) black or blue-line prints of the plans including the items listed in section II below shall be submitted to the Planning & Zoning Administrator for presentation to the Planning Commission.	B. _____ ✓	_____ ✓
C. An adequate number of color photographs (Polaroid-type acceptable) are required to illustrate the site, including buildings and other existing features as well as adjacent properties. Photos may also be used to illustrate installations on other sites that are similar to the applicant's proposal.	C. _____	_____ ✓
D. Materials List	D. _____	_____ ✓
II. BUILDING CONSTRUCTION, EXTERIOR REMODELING, AND ADDITIONS (INCLUDING PARKING LOTS AND LANDSCAPING)		
A. Site Plan. A site plan is required containing the following information:		
1. Scale and north arrow;	1. _____ ✓	_____ ✓
2. Project name and site address;	2. _____ ✓	_____ ✓
3. All property and street pavement lines;	3. _____ ✓	_____ ✓
4. Existing and proposed contours;	4. _____ ✓	_____
5. Gross area of tract stated in square feet;	5. _____	_____
6. Proposed ingress and egress to the site, including on site parking area(s), parking stalls and adjacent streets. Delineate traffic flow with directional arrows and indicate the location of direction signs or other motorist's aids (if any);	6. _____ ✓	_____ ✓
7. The designation of required buffer screens (if any) between the parking area and adjacent property;	7. _____ ✓	_____ ✓
8. Location of all isolated existing trees having a diameter of six (6) inches or more; (Tree masses may be shown with a diagrammatic outline and a written inventory of individual trees exceeding 6" in caliber);	8. _____	_____
9. Existing landscaping that will be retained and proposed landscaping shall be differentiated and shown on the plan. The type, size, number, and spacing of all plantings and other landscape features must be illustrated;	9. _____	_____
10. Identify photograph location;	10. _____	_____ ✓
11. Location of all existing and proposed building on the site	11. _____	_____ ✓
12. Location of all existing (to remain) and proposed lighting standards.	12. _____	_____ ✓
13. Provide breakdown of parking spaces required and spaces provided (see COG 1163);	13. _____	_____

14. Provide interior landscaping breakdown for paved surface (5% of paved surface required to be landscaped with one (1) tree per 100 square feet, see COG 1163)

14. _____

15. Provide lot coverage breakdown of building and paved surface areas.

15. _____

B. Elevations. Complete elevation from all sides of all proposed construction labeled North, South, East and West and related elevations of existing structures (if any) are required containing the following information:

1. Scale;
2. Changes in ground elevation;
3. All signs to be mounted on the elevations;
4. Designation of the kind, color, and texture of all primary materials to be used;
5. Fenestration, doorways, and all other projecting and receding elements of the building exterior.

1. _____ ✓

2. _____

3. _____ ✓

4. _____ ✓

5. _____ ✓

C. Optional requirements at discretion of Planning Commission.

1. Scale model.
2. Section Profiles.
3. Perspective drawing.

1. _____

2. _____

3. _____

D. Material Samples. Material samples are required for all exterior materials. For presentation purposes, a narrative description is required for Planning Commission file.

D. _____

E. Lighting Standard Drawing. A scaled drawing of the proposed lighting standard(s) is required and should contain the following information:

1. All size specifications;
2. Information on lighting intensity (number of watts, isofootcandle diagram, etc., at least 1/2 foot candles required);
3. Materials, colors, and manufacturer's cut sheet;
4. Ground or wall anchorage details.

1. _____

2. _____

3. _____ ✓

4. _____

Planning Commission

Information for All Applicants

1. All required information must be submitted with the application. The Tuesday, four (4) weeks prior to the Public Hearing Date, by 5:00 p.m., is the deadline for acceptance of all applications. No application will be forwarded to Planning Commission until all information is received in the Planning & Zoning Office.
2. It is the responsibility of the applicant to have a court reporter present, at the applicant's expense, if they wish to have a verbatim transcript of the meeting. Council office must be advised in advance if a court reporter is going to be present.
3. Reduced drawings suitable to an 11x17 inch size must be submitted. If an application is amended at any time during the process, a new reduced drawing must be submitted as well as any full size drawings requested.
4. Agendas will be mailed to the applicant on the Friday prior to the Planning Commission meeting. If the agenda is to go to someone other than the applicant, it needs to be noted on the application.
5. If a list of Contiguous Property owners needs to be submitted with an application, it must be compiled in a list on a separate sheet of paper. This must include mailing name and address of property owner. Showing them only on one of the plan sheets is not acceptable.
6. For Design Review applications, a materials list, unless otherwise instructed by the Planning & Zoning Administrator, must be submitted with the application. If materials are changed during the process, then a new materials list must be submitted.
7. For Multi-tenant ground sign & Master Sign Plan applications, location must be noted on a site plan. Also notate location on site plan for a freestanding sign or on building elevation for a wall sign. Color renderings must be submitted.
8. Please review "Submission Requirements" on any application before submitting to the Planning & Zoning Division.
9. Copies of specific sections of the zoning code are available in the Zoning Office at no charge. The entire zoning code with a map is available in the Council Office at a cost of \$25.00. Zoning Code is available on line and can be found @ www.gahanna.gov/departments/development/planning.asp under Code Ordinances.
10. Planning Commission members may visit the property prior to the hearing to review the application.



CITY OF GAHANNA

Agreement to Build as Specified

Your signature below affirms that, as the applicant JEFF BERLING
(Please Print - Applicant Name)
_____ for Compton Construction LLC
(Business Name and/or Address)

you will build the project as approved and specified by the Planning Commission for the City of Gahanna. You, as the applicant, also agree that any necessary change to the project must go back through Planning Commission process to amend the plans.

Applicant Signature [Signature]
(Applicant Name/Applicant Representative)

Date 9.9.15

Fredena L. Williams
(Signature of Notary)

9/9/15
(Date)



Fredena L. Williams
Notary Public, State of Ohio
My Commission Expires 06-28-2017

Stamp/Seal

MATERIAL LIST

Item	Manufacturer Name	Color Name	Color Number
Awnings	n/a, Custom Steel	PT-01 - Benjamin Moore Onyx	2133-10
Brick	Glen-Gary Brick	WF-01 - St. Windsor, Red	n/a
Gutters and Downspouts	Existing aluminum gutters/downspouts to remain	PT-01 - IFS Coatings Matte Aluminum	n/a
Lighting	Barnlightelectric.com	Elliptical sign light black	100-black
Roofing	Existing standing seam metal roof to remain	Silver	n/a
Siding	Existing corrugated metal siding to remain	PT-01 - IFS Coatings Matte Aluminum	n/a
Signs	n/a, Custom metal channels & painted	Black on metal channels & PT-02 onyx/PT-03 pure white	2133-10 & OC-63
Stucco	n/a	n/a	n/a
Trim & coping	Dimensional Metals, Inc.	black	n/a
Windows	Thermal Windows, Inc.	Black	n/a
Garage Door	Aluminum door systems	anodized aluminum - 511 series	n/a
Patio Railing	Custom	galvanized tube steel & metal mesh - black finish & cedar frame clear sealer	n/a

501 GAHANNA LLC
501 MORRISON RD, SUITE 100
GAHANNA, OH 43230

September 9, 2015

City of Gahanna Zoning Board

RE: SHARED PARKING ARRANGEMENT

To Whom It May Concern:

This letter summarizes the shared parking arrangement between 501 and 505 Morrison Road buildings located in Gahanna, Ohio. Both buildings are located on the property owned and operated by 501 Gahanna LLC, 501 Morrison Road, Suite 100, Gahanna, Ohio 43230. There are currently 81 parking spaces on the property. (See attached site plan for reference).

The 501 Morrison Road building is a two story office building with multiple tenants. All businesses operate during normal working hours of 8 am – 5 pm. The following is a list of businesses located within the 501 Morrison Rd building: Stage Capital, SF Mgmt, BlankenBecler Advisors, Covenant Title, Ohio Association of Gifted Children and SOH Productions.

The 505 Morrison Road building is a one story building with a single tenant, Kindred Ales. Kindred Ales will be using the building as a tasting room and beer aging facility. This business will operate during the following hours:

Monday	Closed
Tuesday	Closed
Wednesday	Closed
Thursday	4 pm – 12 am
Friday	4 pm – 12 am
Saturday	12 pm – 12 am
Sunday	12 pm – 12 am

The employees and customers of Kindred Ales using the 505 Morrison Road building will use the vacated parking spaces of the employees of the businesses in the 501 Morrison Road building. This arrangement will allow for more than adequate parking for Kindred Ales use of the 505 Morrison Road building, which would require 29 spaces for the bar area and 3 for the beer aging/warehouse area.

Respectfully,
501 Gahanna LLC

By: 
Michael A. Mess
Its: Secretary



501 Morrison Rd, Gahanna, OH 43230

My Notes

On the go? Use m.bing.com to find maps, directions, businesses, and more

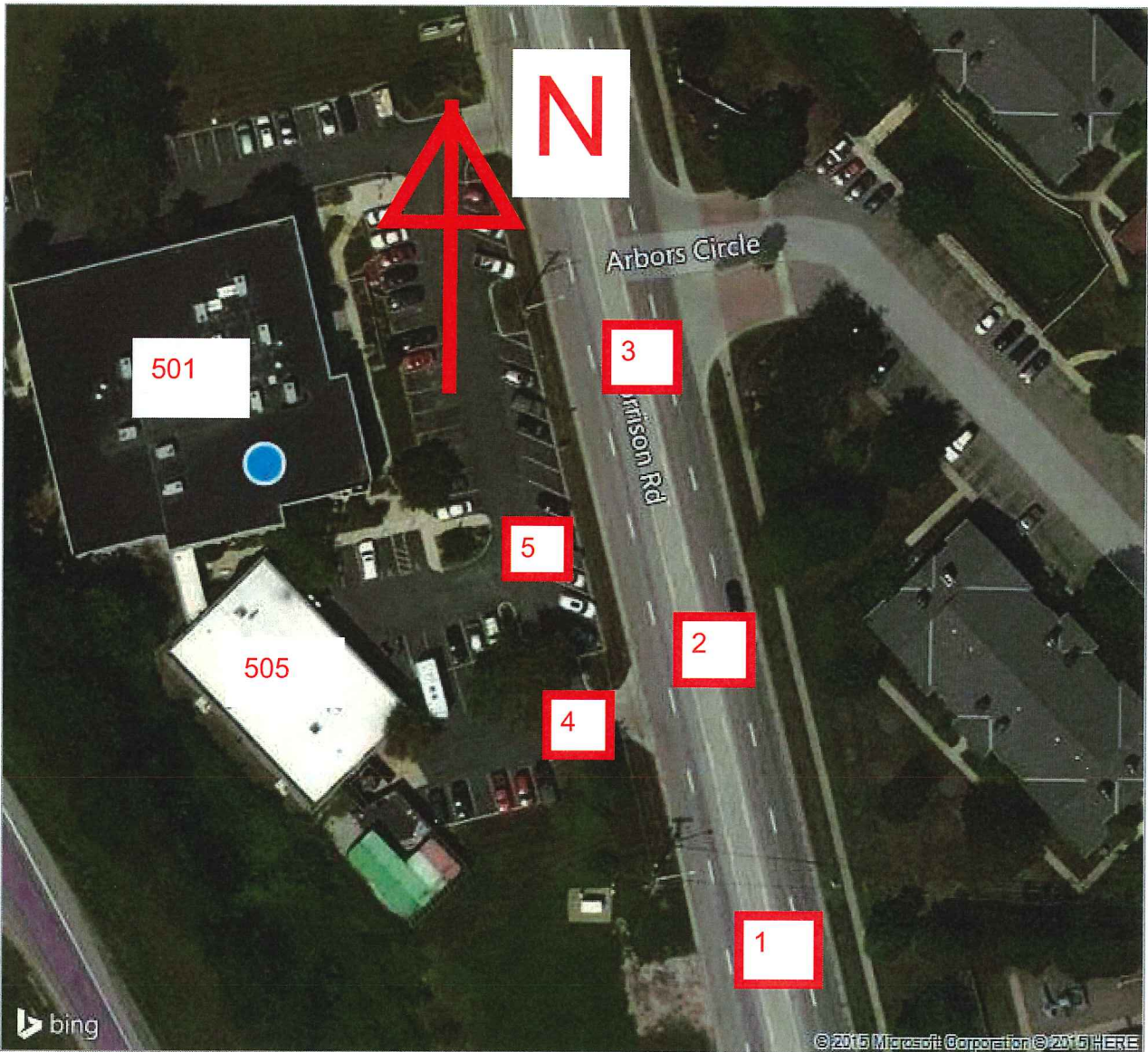
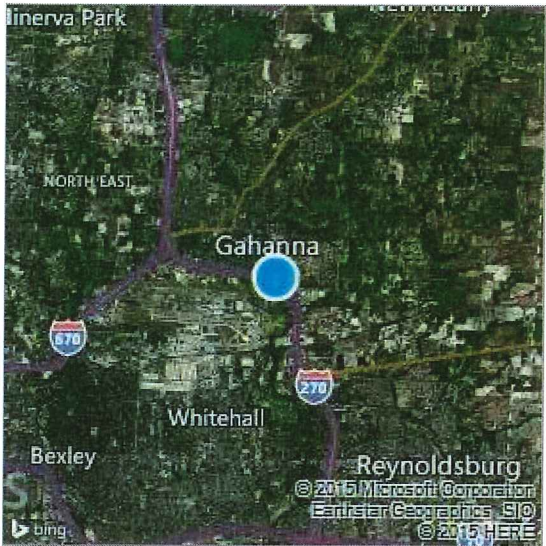

NEW APPLICATION ACCEPTANCE

Submission Reviewed for completeness

Date:

Items needed:

Submittal Accepted Date

Date:

Ready for Council by Date

Date:

What is hearing Date

Date:

Oct 14

Staff Meeting to be scheduled?

yes

no

Date:

Time:

Staff Attendies:

Additional Notes:



RECEIVED
SEP 17 2015
BY *gaw*

floor plan not to scale

- 1 green scape
- 2 retail, mobile cart
- 3 viewing counter, 42" aff
- 4 re-purposed industrial table
- 5 lounge
- 6 barrel sinks, partial barrels to meet ada

SEATING COUNTS

28 outside

44 inside

21 bar

9 counter

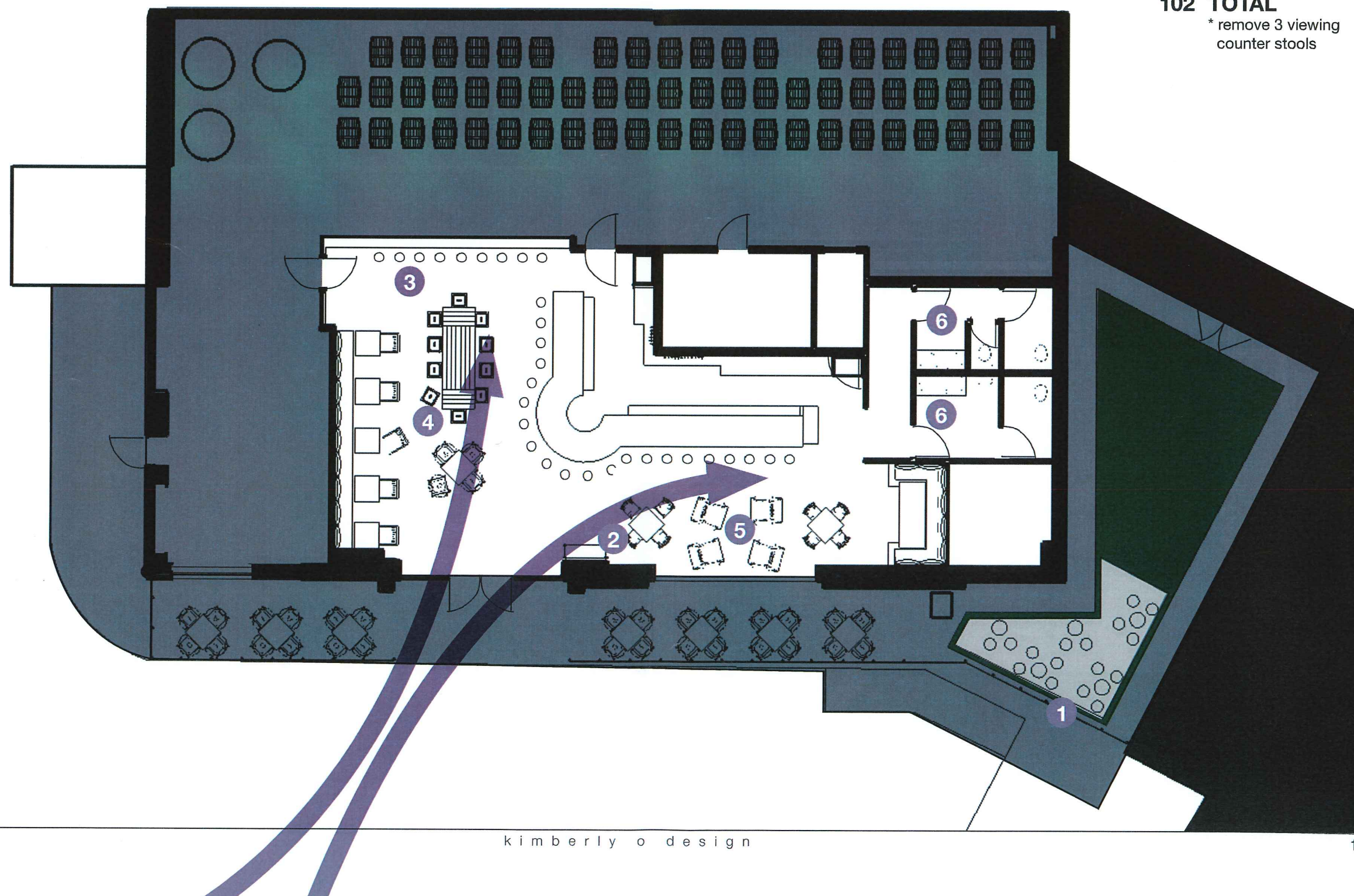
102 TOTAL* remove 3 viewing
counter stools

lighting plan not to scale

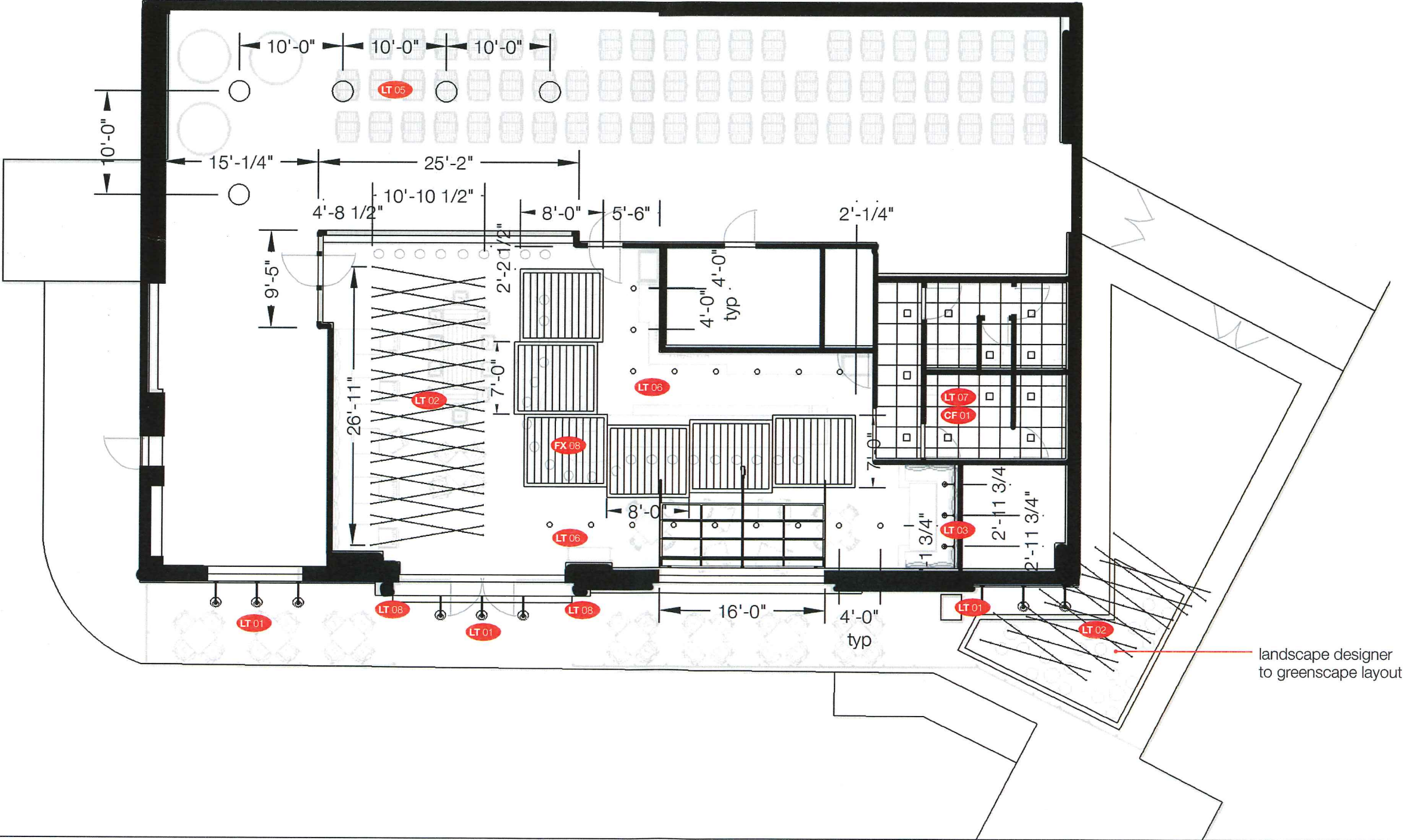

exterior elevations not to scale

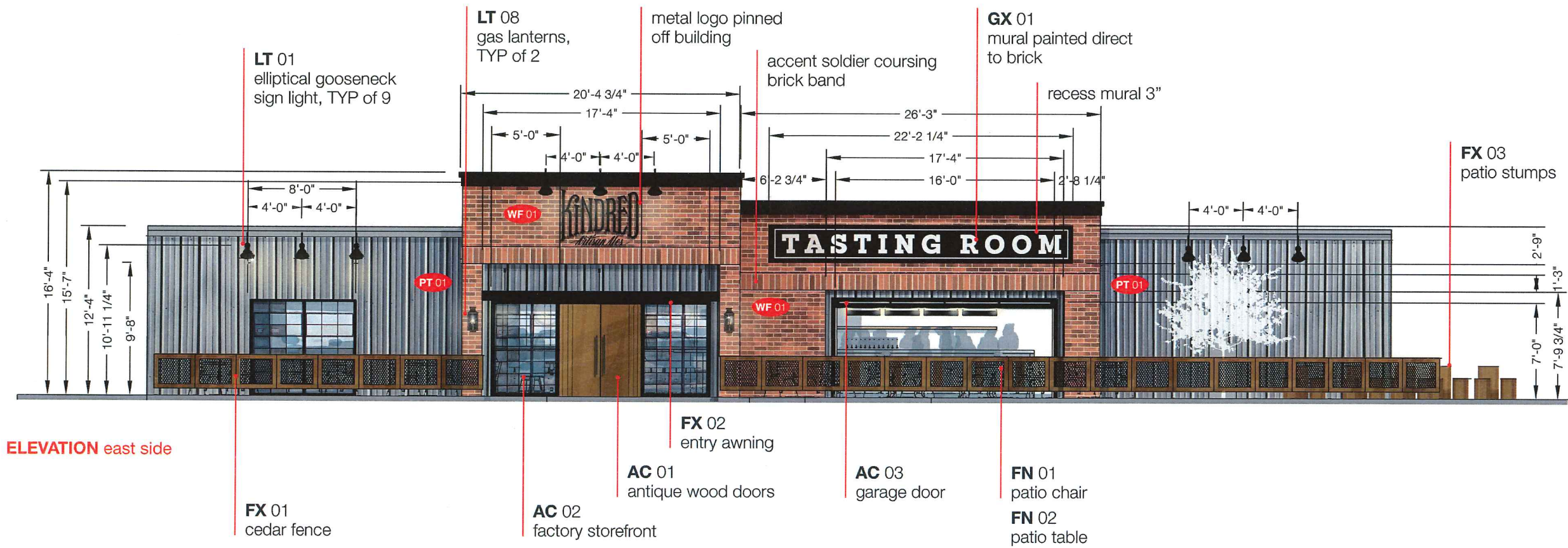

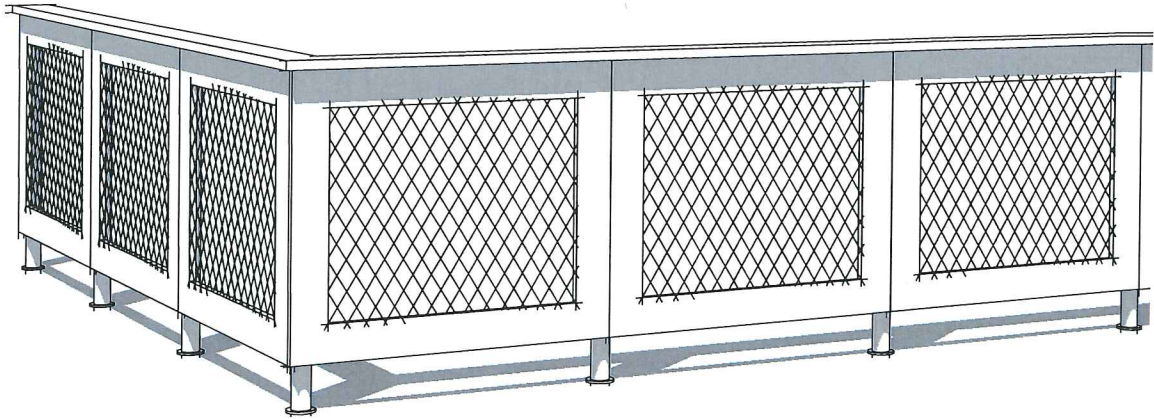

FX 01
Patio Rail
1/4" = 1'-0"

- NOTES**
1. Site verify overall dimensions

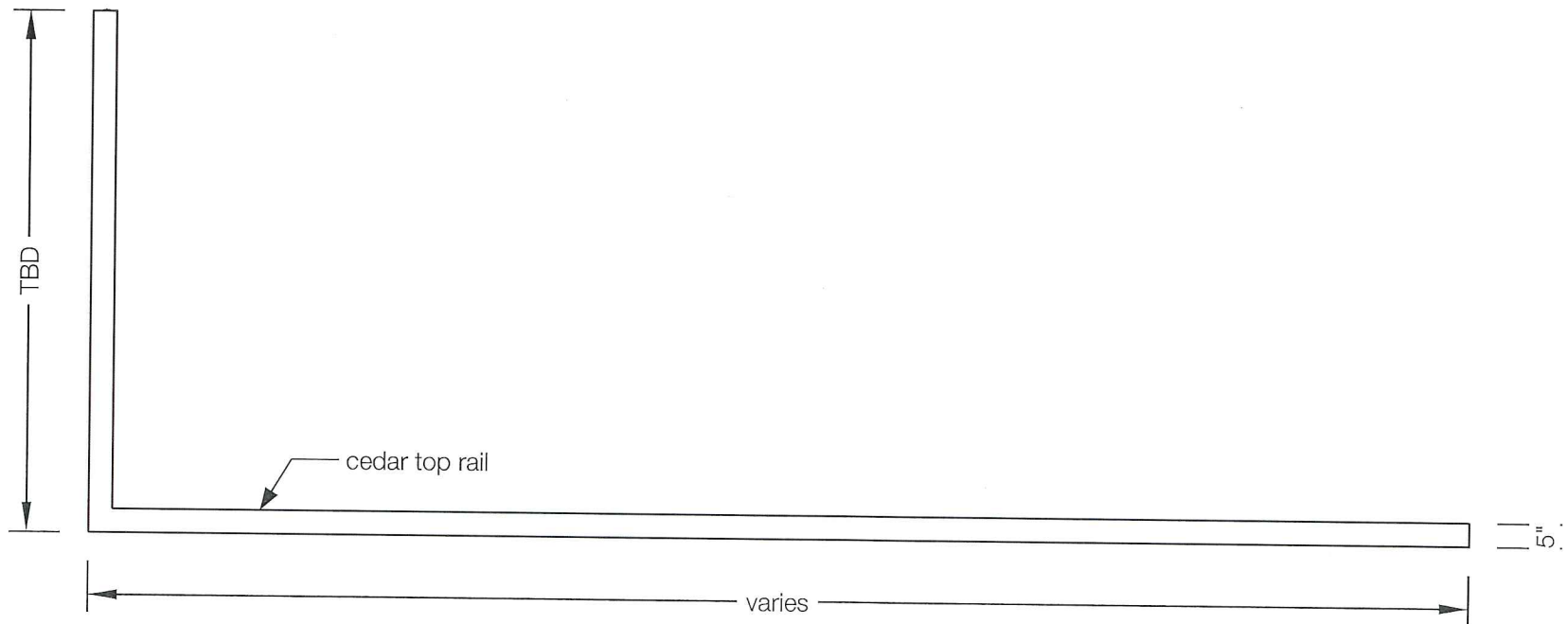

PLAN top view

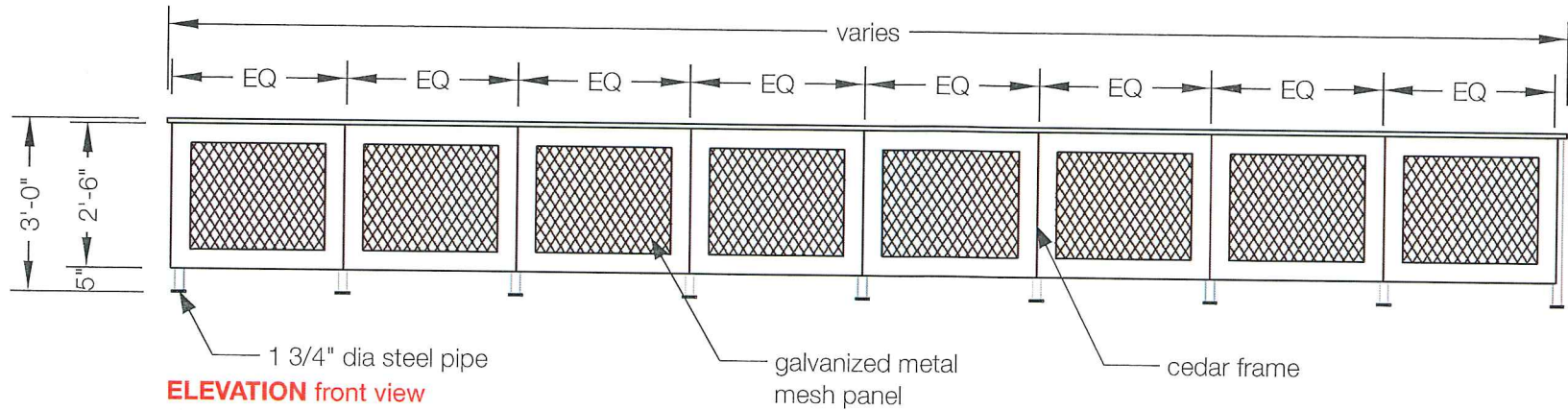

ELEVATION front view



FX 02
Entry Awning
1/4" = 1'-0"

- NOTES**
- 1. Site verify overall dimensions
 - 2. Refer to image below for style reference
 - 3. See page 38 for FINISHES
- PT** = Paint

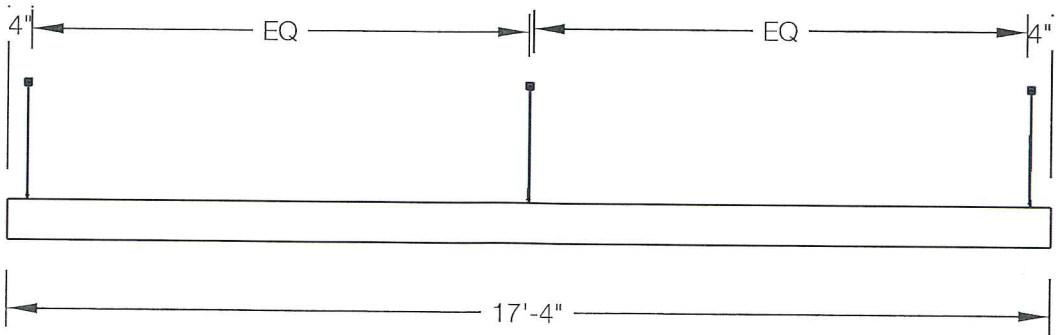
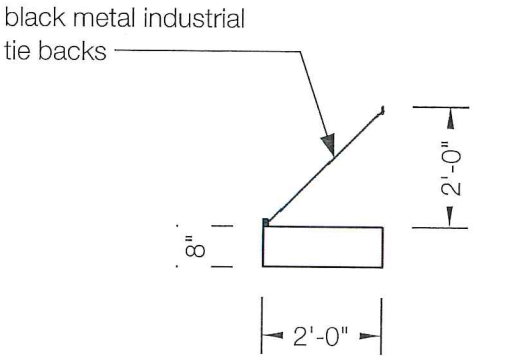
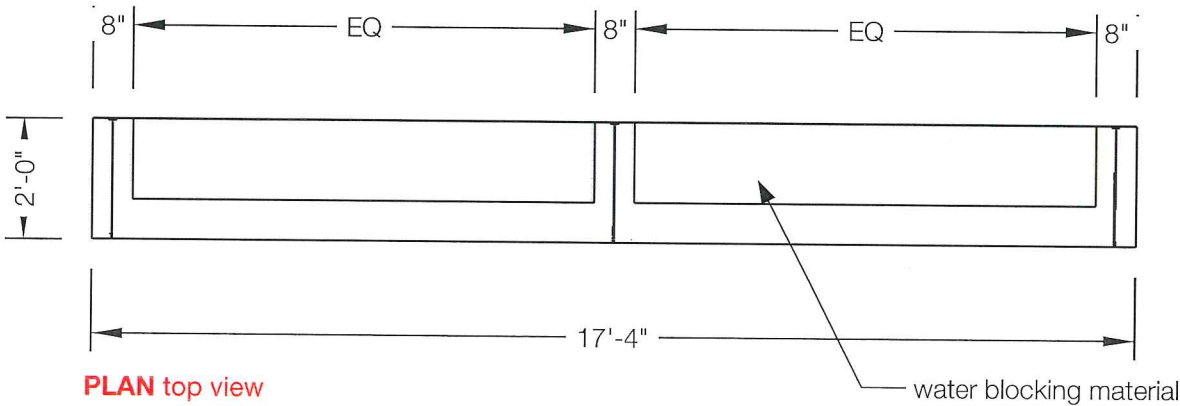

FX 03
Greenscape Seating
3/4" = 1'-0"

- NOTES**
- 1. Site verify greenspace design for quantity and layout
 - 2. Refer to image below for style reference

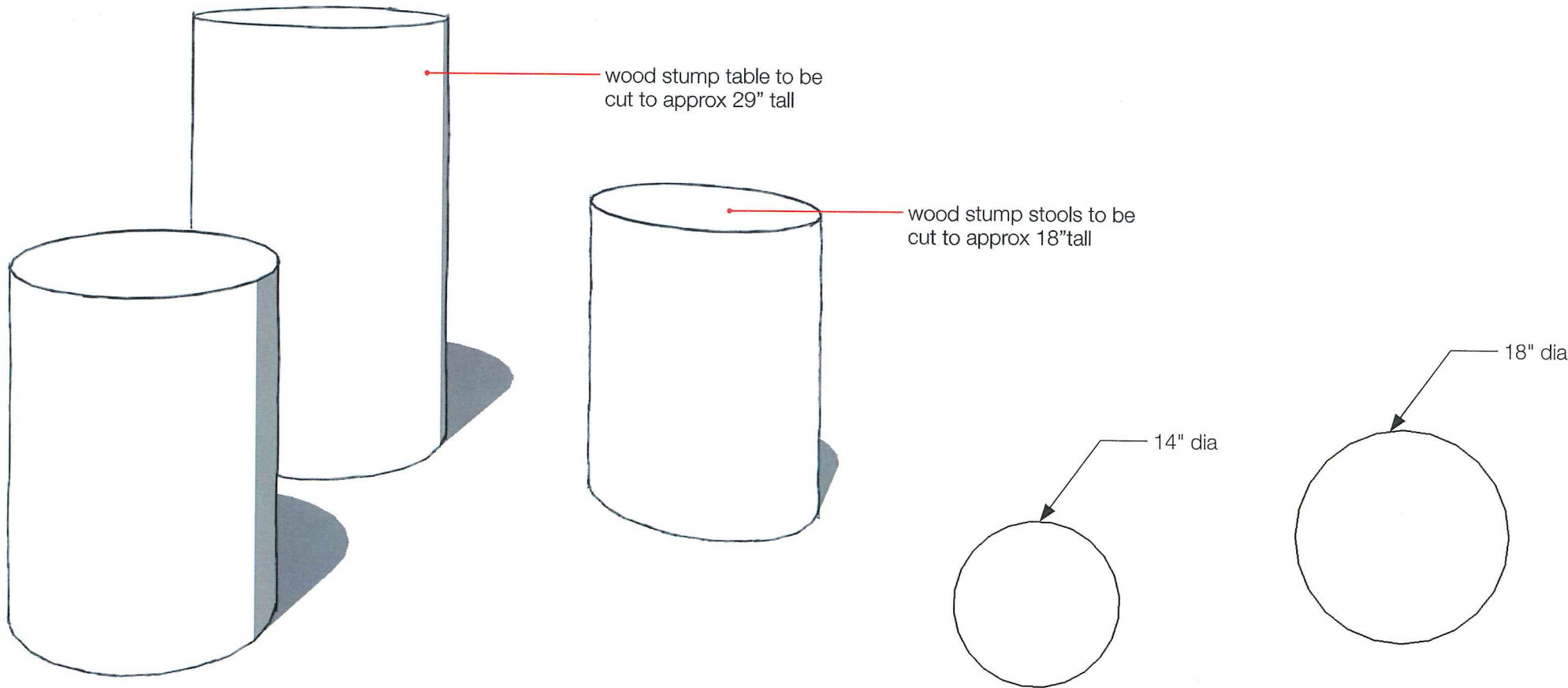

PLAN top view (stool)

PLAN top view (table)

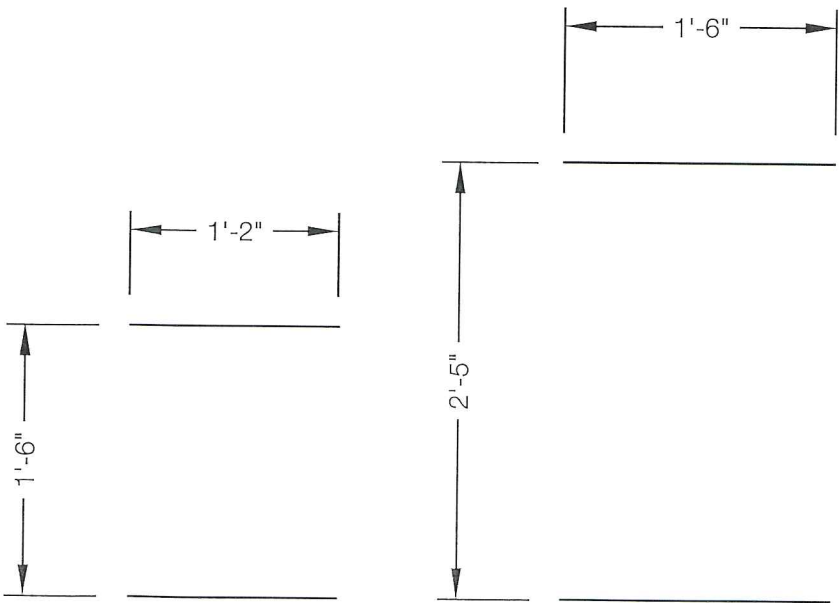

ELEVATION front view (stool)

ELEVATION front view (table)



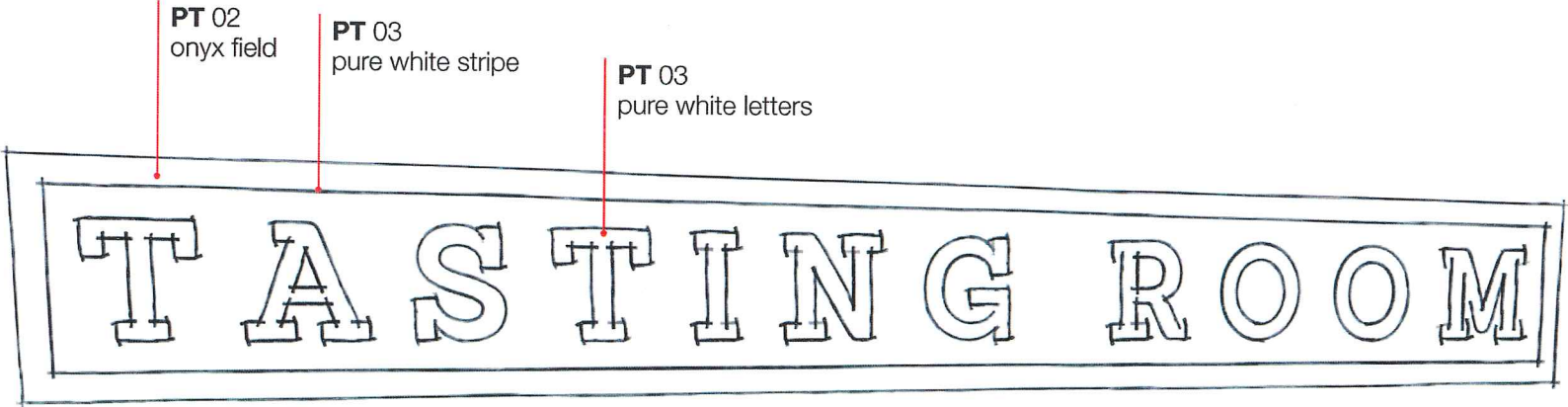

GX 01
Painted Mural
3/8" = 1'-0"

- NOTES
1. Site verify overall dimensions
 2. Mural to be painted direct to brick
 3. Font to be Sanchez Black
 4. See page 38 for FINISHES

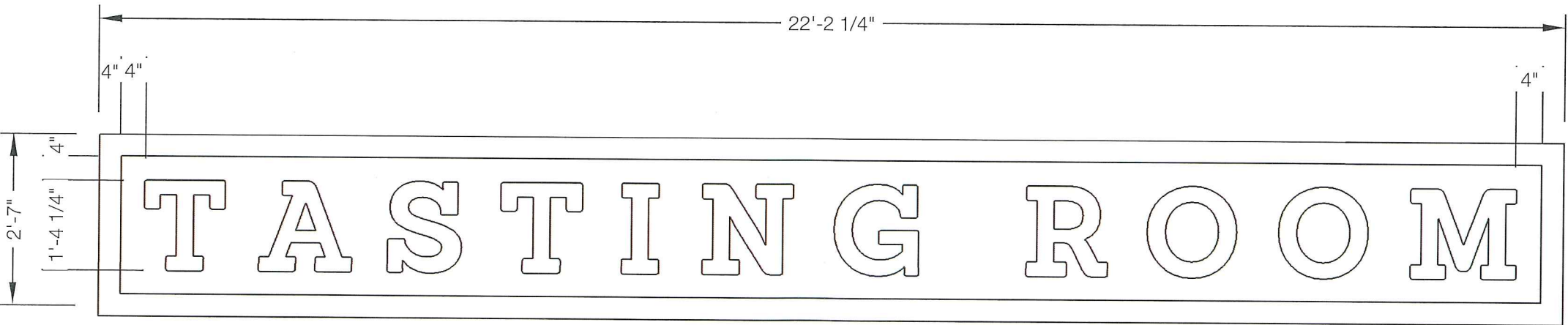

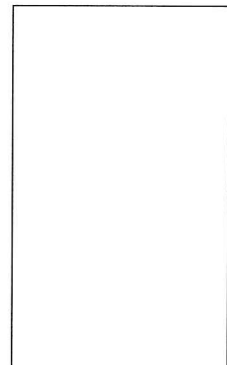
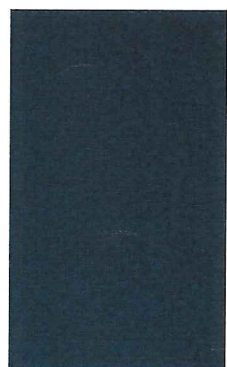
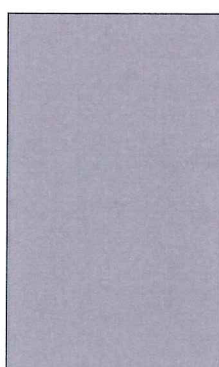
**MTL 01** Copper Metal**Finish** Copper Pipe**Location** Bar Foot Rest**PT 01** Paint**Manufacturer** IFS Coatings Inc.**Contact** (866) 437-2864**Color** Matte Aluminum**SRL** 91662**Location** Corrugated Building, Gutters,
Outside Mechanicals**NOTES** Paint existing metal building**PT 02** Paint**Manufacturer** Benjamin Moore**Color** 2133-10 Onyx**Finish** Satin Gloss**Location** Trim, Storage Area, **GX 01****NOTES** Black to match storefront system**PT 03** Paint**Manufacturer** Benjamin Moore**Color** OC-63 Pure White**Finish** Satin Gloss**Location** **GX 01****PT 04** Paint**Manufacturer** Benjamin Moore**Color** 2121-10 Gray**Finish** Eggshell**Location** Trusses, Ceiling, Ductwork**PT 05** Paint**Manufacturer** Benjamin Moore**Color** 2005-10 Red Rock**Finish** Eggshell**Location** Walls**PT 06** Paint**Manufacturer** Benjamin Moore**Color** HC-158 Newburg Green**Finish** Eggshell**Location** Walls**PT 07** Paint**Manufacturer** Benjamin Moore**Color** 2116-50 African Violet**Finish** Eggshell**Location** Restroom Walls**PT 08** Paint**Manufacturer** Benjamin Moore**Color** 2073-10 Dark Purple**Finish** Eggshell**Location** Restroom Walls**SF 01** Surface Finish

Sean Watson (724) 980-1338

Manufacturer Richlite**Style** Northwest**Color** Black Diamond**Cost** \$30 / sq ft plus freight**Location** Bar Top**Lead Time** 4 weeks**SF 02** Surface Finish**Distributor** Ohio Valley Supply

John Kuna (937) 477-2108

Manufacturer DuPont**Collection** Zodiaq Quartz**Color** Stratus White, 3 cm**Location** Restroom Vanity**Cost** \$21 / sq ft plus freight**Lead Time** 4 weeks**UP 01** Upholstery

Belinda Binford (513) 310-6696

Manufacturer Carnegie**Pattern** Hide 6514 19**Cost** \$39 / 54" wide yard plus freight**Location** Banquette, Booth**Lead Time** 2-3 weeks



UP 02 Upholstery
Julie Brinkworth (800) 221-1540
Manufacturer Designtex
Pattern Berber Stripe 3268-802
Color Charcoal
Cost \$ \$57.90 / 55" wide yard plus freight
Location Booth
Lead Time 2-3 weeks

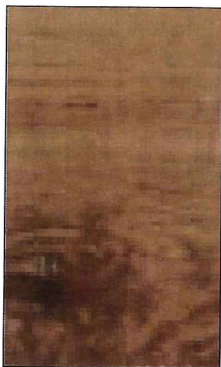

WB 01 Wood Base
Finish 4" Natural Reclaimed Wood
Location Dining



WD 01 Reclaimed Wood
Source Raw Workspace
Brad Richard (740) 610-5620
Color Natural
Location Fixtures
Cost varies
Lead Time 1 week



WD 02 Weathered Wood
Source Raw Workspace
Brad Richard (740) 610-5620
Color Gray Weathered
Location Ceiling Fixture
Cost varies
Lead Time 1 week

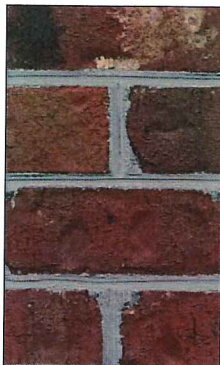

WF 01 Brick
Distributor Hamilton Parker
Brenda Tepper (614) 332-4549
Manufacturer Glen-Gary Brick
Style 1/2" Modular Thin St. Windsor
Location Exterior, Interior
Cost \$54.08 / box (10sf / bx)
Lead Time 2-3 weeks

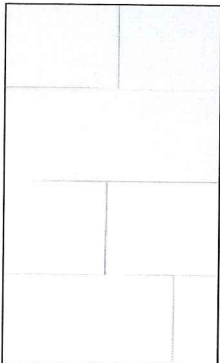

WF 02 Wall Tile
Source The Home Depot
Manufacturer US Ceramics
Style Bright Snow 3"x6" Subway Tile
Location Back Bar, Restrooms
Cost \$2.63 / sq ft
Lead Time 2-3 weeks
NOTE Grout to be Bostik White H152
Use 6"x6" cove base at floor in restrooms

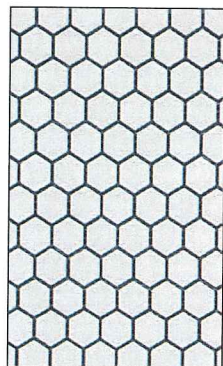

WF 03 Wall Tile
Distributor Hamilton Parker
Brenda Tepper (614) 332-4549
Manufacturer US Ceramics
Style White 1"x1" Hex Mosaic Tile
Location Bar Front
Cost \$TBD
Lead Time 2-3 weeks
NOTE Grout to be Bostik White H152



WF 04 Corrugated Metal
Color To Match Exterior
Location Warehouse

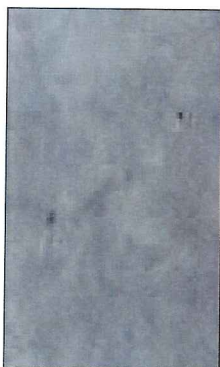

FF 01 Concrete
Color Natural, sealed
Location Throughout

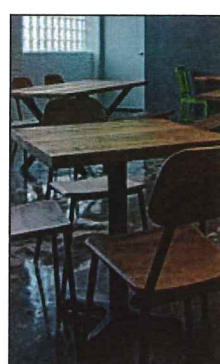
**FN 01** Patio Chair**Source** Overstock.com**Style** Tabouret Bistro Gunmetal Side Chairs**ITEM#** 16599815**Cost** \$166.99 (set of 2)**Lead Time** 2 weeks**Location** Patio**FN 02** Patio Table**Source** Overstock.com**Style** Tabouret Gunmetal Dining Table**ITEM#** 16190405**Cost** \$ 159.99**Lead Time** 2 weeks**Location** Patio**FN 03** Antique Arm Chairs**Source** Flea Markets**Location** Entry**NOTES** 4 Mis-matched chairs, Wear is good!**FN 04** Dining Chair**Source** Overstock.com**Style** Vintage Tabouret Stacking Chairs**ITEM#** 14366775**Cost** \$209.99 (set of 4)**Lead Time** 2 weeks**Location** Dining**FN 05** Dining Table**Source** Etsy.com**Shop** UrbanWoodGoods

Reclaimed Wood Cafe Table

Size 30"x30"**Finish** Oil**Cost** \$495**Lead Time** 4 weeks**Location** Dining**FN 06** Banquette Chair**Source** Overstock.com**Style** Sunpan Harrison Upholstered Dining Chairs**ITEM#** 16388204**Cost** \$615.82 (set of 2)**Lead Time** 2 weeks**Location** Banquette**FN 07** Community Stool**Source** Overstock.com**Style** Zuo Marius Antique

Black Goldtone Stool

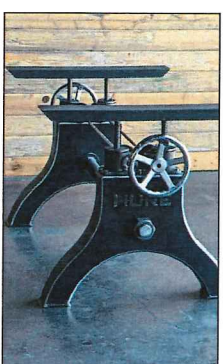
ITEM# 16358668**Cost** \$158.99 (set of 2)**Lead Time** 2 weeks**Location** Community Table**FN 08** Counter Stool**Source** Overstock.com**Style** Machinist Rustic Wood Seat Adjustable Barstool**ITEM#** 17136404**Cost** \$122.99 ea**Lead Time** 2 weeks**Location** Bar**FN 09** Bar Stool**Source** Overstock.com**Style** Industrial Swivel Barstool**ITEM#** 17070287**Cost** \$129.68 ea**Lead Time** 2 weeks**Location** Lounge**FN 10** Community Table Base**Source** Vintageindustrial.com**Style** Hure Crank Table Base**ITEM#** 16358668**Cost** \$12,595**Lead Time** 4-6 weeks**Location** Community Table**AC 01** Antique Wood Doors**Source** Etsy.com**Shop** VintageSignora**Finish** Wood**Location** Entry**Cost** \$1200 plus shipping**Lead Time** 2 weeks

NOTE Decorative door pull tools to be provided by owner, mount to metal plate

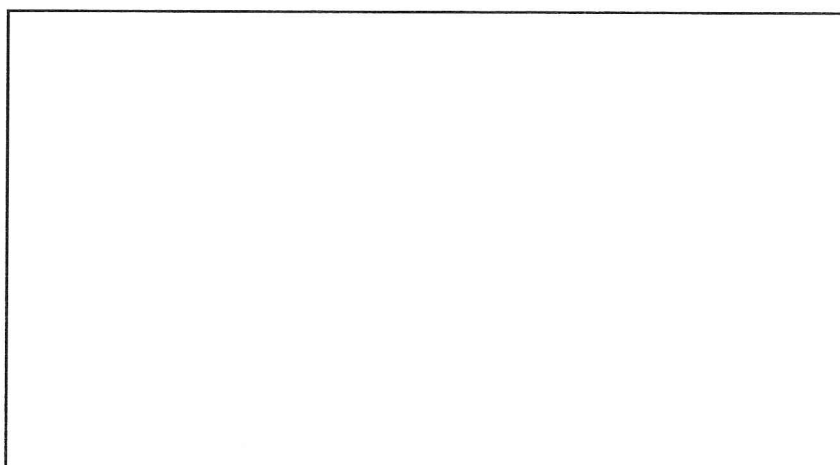

**AC 02 Factory Storefront**

Distributor Northern Window & Door
Mike Laparo (614) 778-7551

Manufacturer Thermal Windows, Inc

Style 6' x 9' factory-style spacing

Color Black

Location Exterior

**AC 03 Garage Doors**

Distributor Graf & Sons

Jeff Williams (614) 481-2020

Manufacturer Overhead Door

Style Series 521

Color Black

Location Patio

**AC 04 Mobile Retail Cart**

Source Overstock.com

Style Metal/ wood Rolling Storage Shelf

ITEM# 16897870

Size 63" high x 16" wide x 40" long

Cost \$309.99

Lead Time 2 weeks

Location Mobile

**AC 05 Restroom Faucet**

Source Ferguson.com

Manufacturer Kohler

Collection Purist

8" Widespread Bathroom Sink Faucet

Item K14406-4-BN

Finish Vibrant Brushed Nickel

Cost \$603.07

Lead Time 2 weeks

Location Restroom

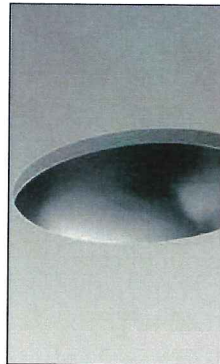
**AC 06 Restroom Faucet**

Source Ferguson.com

Manufacturer Kohler

Collection Bachata

Undermount Bathroom Sink

Item K2608-SU-NA

Finish Stainless Steel

Cost \$106.06

Lead Time 2 weeks

Location Restroom

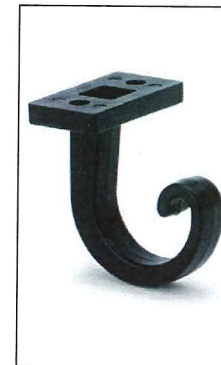
**AC 07 Purse Hook**

Source Webrestaurantstore.com

Style Table Handbag Hook, plastic

Item 8081650

MRF Item 1650

UPC Code 727875089137

Cost \$3.80 (set of 2)

Lead Time 2 weeks

Location Bar

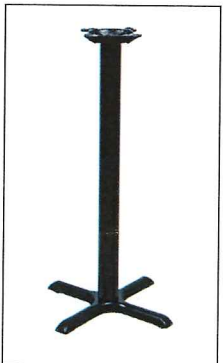
**AC 08 Bar Height Base**

Source Webrestaurantstore.com

Style ancaster Table & Seating 22" x 22" x 41"

Black Metal Table Base - Bar Height

Item 349B0142

UPC Code 708879016107

Cost \$34.99

Lead Time 2 weeks

Location High Booth

**AC 09 10" Stem Rack**

Source Wayfair.com

Manufacturer Wine Enthusiast Companies

Style Hanging Tabletop Wine Glass Rack

SKU WINE1066

Cost \$30.99

Lead Time 2 weeks

Location Back Bar

**LT 01** Goose Neck**Source** BarnLightElectric.com**Product** The Elliptical Sign Light**Finish** 100-Black**Shade Size** 11"**Goose Neck Arm** G22 Gooseneck Arm

21 1/2" Projection

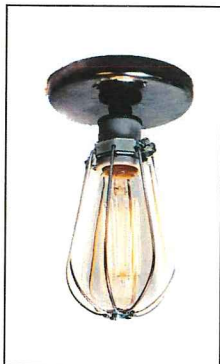
Cost \$229 plus shipping**Lead Time** 2 weeks**Location** Exterior Accent**LT 04** Bulb and Socket**Source** BJunkyardlighting.com**Product** Industrial Bare Bulb Caged Light

Ceiling Flush Mount / Wall Sconce

Finish steel silver canopy**Cost** \$69 plus shipping**Lead Time** 2 weeks**Location** Ceiling Fixture**LT 07** Recessed Light**Source** 1800lighting.com**Manufacturer** WAC Lighting**Style** 4 Inch LED Energy Smart 5 Inch

Recessed Lighting Trim

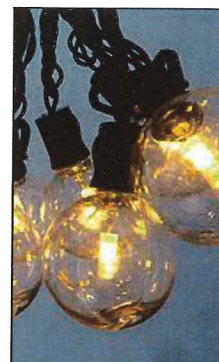
Product HR-LED471**Color** White**Capitol ID** 1290722**MFR SKU** HR-LED471-WT**Cost** \$448.00 plus shipping**Lead Time** 2 weeks**Location** Restrooms**LT 02** String Lights**Source** Oolgalights.com**Style** 20' Amber LED Heavy Duty Globe

String Lights - 25 Lights

SKU 713757**Cost** \$29.95 plus shipping**Lead Time** 2 weeks**Location** Patio + Dining**LT 05** Warehouse Pendant**Source** Shadesoflight.com**Style** Large Industrial Enameled Shade

Warehouse Pendant

SKU PE13234 WH**Color** White**Cost** \$448.00 plus shipping**Lead Time** 2 weeks**Location** Warehouse**LT 08** Gas Lantern**Manufacturer** Carolina Lanterns**Contact** (843) 881-4170**Product** Carolina Collection, Aspen Lantern**Mount Type** ASPM

22 5/8 X 11 1/8 X 10 1/16

Color Original Copper**Cost** \$750 plus shipping**Lead Time** 2 weeks**Location** Exterior**LT 03** Pulley Sconce**Source** Etsy.com**Shop** IroncladIndustrial**Style** Vintage Industrial Large Pulley Sconce

Lamp. Plug in.

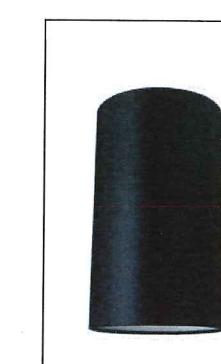
Cost \$179 plus shipping**Lead Time** 4 weeks**Location** Booth**LT 06** Ambient Light**Distributor** Spectrum Lighting

Melanie Gagnon (614) 453-9067

Manufacturer HI-LITE MFG.CO., INC

(909) 465-1999

Style Cylinder Collection,**Product** 6" x 10" H-16044,

Cord Mounted, LED

Color 91 Black**Cost** \$351.00 plus freight**Lead Time** 2 weeks**Location** Dining**CF 01** Tin Ceiling**Manufacturer** Armstrong

Mike McDowell 717.396.6052

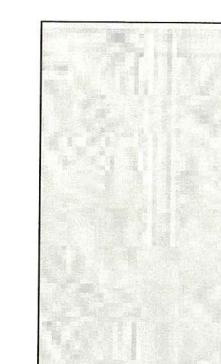
Visual Design 56006 B1L9**Dimensions** 24in x 24in, B1 Unperforated**Shape** 9/16 Square Lay-in**Color** White**Cost** \$7.90-8.90 / sq ft installed**Lead Time** 4 weeks**Location** Restrooms**Notes** Use with 2 5/8" cornice 56053













CITY OF GAHANNA

STAFF COMMENTS

Project Name: Kindred Ales

Project Address: 505 Morrison Rd

Planning and Development

The proposed project is located within the Hamilton Road Corridor Plan's South Gateway District. Design statements include the following: buildings should be constructed of quality materials; use of traditional materials; buildings should provide visual interest to passer-by traffic; and use of architectural elements to provide visual interest. The Plan recommends signage that is smaller with more restraint graphics and signage that complements the building.

It is staff's opinion that the proposal is consistent with the recommendations of the Hamilton Road Corridor Plan.

Location Map



"HERB CAPITAL OF OHIO"

200 SOUTH HAMILTON ROAD, GAHANNA, OH 43230
614-342-4000 PHONE 614-342-4100 FAX WWW.GAHANNA.GOV



CITY OF GAHANNA

Current Condition



"HERB CAPITAL OF OHIO"

200 SOUTH HAMILTON ROAD, GAHANNA, OH 43230
614-342-4000 PHONE 614-342-4100 FAX WWW.GAHANNA.GOV



CITY OF GAHANNA

South Gateway Images

Likes



Dislikes

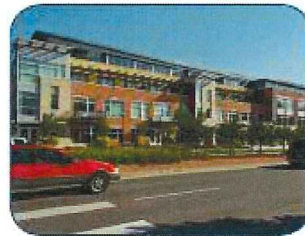
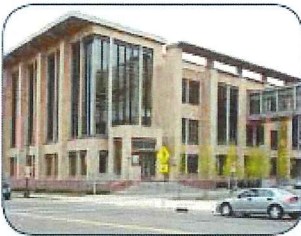

Respectfully Submitted By:
Michael Blackford, AICP
Deputy Director, Planning and Development





CITY OF GAHANNA

STAFF COMMENTS

Project Name: Kindred Ales

Project Address: 505 Morrison Rd

The new tenant at this address proposes to upgrade the building to provide a tasting room for their beer products, which will be brewed in the OCT district. The exterior materials and finishes are detailed on pages 40 and 41 of the submission documents. The exterior elevation is illustrated on page 16, with lighting illustrated on page 44, and the detail for the patio railing provided on page 19. The metal awning over the front door can be found on page 20. Greenspace seating will be provided at the north end of the building.

These proposed changes will vastly improve the look of the building, and provide interest along the Morrison Road corridor. As the property owner also owns 501 Morrison Road, any overflow parking needs can be accommodated by that parking area.

Signage will be approved administratively.

Respectfully Submitted By:

Bonnie Gard



"HERB CAPITAL OF OHIO"

200 SOUTH HAMILTON ROAD, GAHANNA, OH 43230
614-342-4000 PHONE 614-342-4100 FAX WWW.GAHANNA.GOV