

27.9 ACRE ANNEXATION TO THE CITY OF GAHANNA
SITUATED IN THE STATE OF OHIO, COUNTY OF FRANKLIN, TOWNSHIP OF JEFFERSON
LOCATED IN QUARTER TOWNSHIP 3, TOWNSHIP 1, RANGE 16
UNITED STATES MILITARY DISTRICT

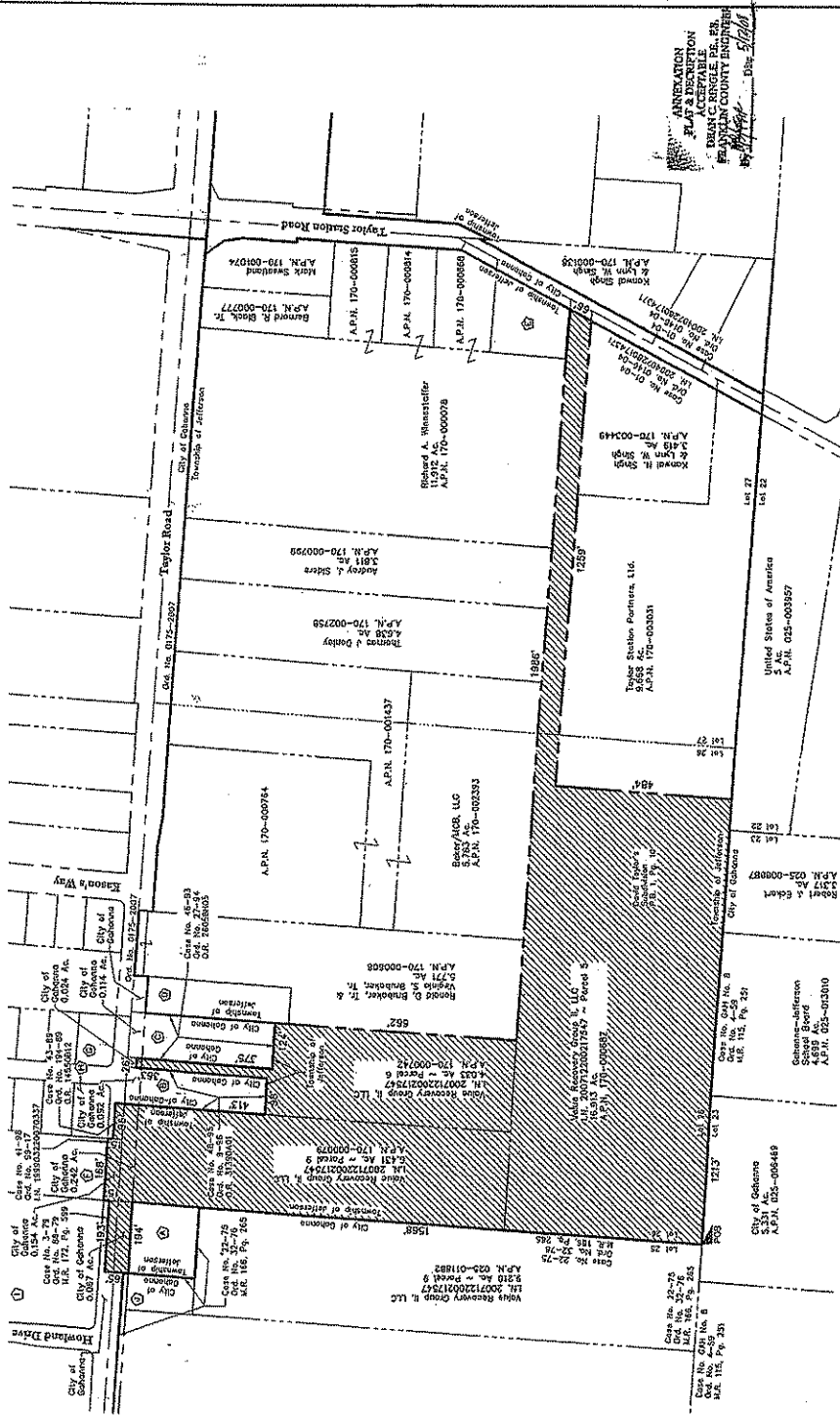

- ① Greg A. Stenrock & Paula Stenrock
A.P.N. 170-000315
0.759 Ac.
- ② Village Recovery Group II, LLC
A.P.N. 025-01179
0.759 Ac.
- ③ Donald G. Witt
A.P.N. 025-01179
0.759 Ac.
- ④ Robert A. Witt
A.P.N. 025-01179
0.759 Ac.
- ⑤ Richard A. Witt
A.P.N. 170-000770
1.0 Ac.
- ⑥ Richard A. Witt
A.P.N. 025-01179
0.759 Ac.
- ⑦ Faye Horn & Amy Horn
A.P.N. 025-00874
0.759 Ac.
- ⑧ Brian McGowan
A.P.N. 025-00874
0.759 Ac.
- ⑨ Rainburn Village Condominium Second Amendment
A.P.N. 025-00874
0.759 Ac.
- ⑩ David L. Beckett
A.P.N. 025-00874
0.759 Ac.



LEGEND

- AREA TO BE ANNEXED
- EXISTING CORP LINE
- PROPOSED CORP LINE

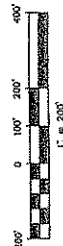

NOTES:

The total length of the annexation perimeter is 5,313 feet, of which 4913 feet is contiguous with the City of Gahanna, leaving 400 feet contiguous. This annexation does not create any unincorporated islands. All dimensions shown herein are approximate.

REV: 05/13/2008	ANNEX NO.
DRAWN BY: JCD	ORD. NO.
DATE: 04/18/2008	JOB NO: 07-0003-188
CHECKED BY: JCD	



432 BEECHER ROAD
GAHANNA, OHIO 43230
PH: 614-424-789 FAX: 614-424-755

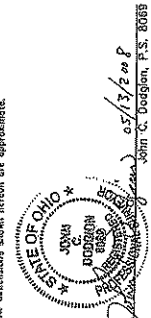

05/13/2008
John C. Dodgson, P.E. 8069

Annexation
Petition
EXHIBIT B

EXHIBIT A

**DESCRIPTION OF 27.9 ACRES LOCATED IN JEFFERSON
TOWNSHIP TO BE ANNEXED TO THE CITY OF GAHANNA
EXPEDITED II ANNEXATION UNDER ORC §709.021 AND §709.023**

Situated in the State of Ohio, County of Franklin, Township of Jefferson, Quarter Township 3, Township 1, Range 16, United States Military District, and being: all of Parcels 5 & 6 and part of Parcel 9 as shown in the deed to Value Recovery Group II, LLC of record in Instrument Number 200712200217547 and part of the right-of-way of Taylor Road and described as follows:

Beginning at the southwest corner of said Parcel 5, the same being a southeast corner of said Parcel 9 and the southwest corner of Lot 26 of "David Taylor's Subdivision" as recorded in Plat Book 1, Page 10, in an existing City of Gahanna Corporation Line as established by Case No. GAH No. 8, Ord. No. 4-59, Misc. Record 115, Page 251;

Thence **Northerly**, partly with an existing City of Gahanna Corporation Line as established by Case No. 22-75, Ord. No. 32-76, Misc. Record 166, Page 265, about 1568 feet to the south right-of-way for Taylor Road;

Thence **Westerly**, with said south right-of-way line, about 194 feet to said existing City of Gahanna Corporation Line as established by Case No. 22-75, Ord. No. 32-76, Misc. Record 166, Page 265;

Thence with the existing City of Gahanna Corporation Line as established by:

1. Case No. 22-75, Ord. No. 32-76, Misc. Record 166, Page 265
2. Case No. 3-79, Ord. No. 88-79, Misc. Record 172, Page 599
3. Case No. 41-98, Ord. No. 99-17, Instrument Number 199903220070337
4. Case No. 43-89, Ord. No. 194-89, Official Record 14550B12
5. Case No. 48-95, Ord. No. 9-96, Official Record 31390A01
6. Case No. 46-93, Ord. No. 27-94, Official Record 26058H05

, the following courses;

Northerly, about 65 feet;

Easterly, about 193 feet;

Northerly, about 15 feet;

Easterly, about 168 feet;

Southerly, about 15 feet;

Easterly, about 96 feet;

Southerly, about 413 feet;

Easterly, about 98 feet;

Northerly, about 363 feet;

Easterly, about 26 feet;

Southerly, about 375 feet;

Easterly, about 124 feet to a northeast corner of said Parcel 6, the same being the southeast corner of said Case No. 46-93, Ord. No. 27-94, Official Record 26058H05;

Thence **Southerly**, with an east line of said Parcel 6, about 662 feet to the southeast corner thereof, in the north line of said Parcel 5;

DESCRIPTION OF 27.9 ACRES LOCATED IN JEFFERSON
TOWNSHIP TO BE ANNEXED TO THE CITY OF GAHANNA
EXPEDITED II ANNEXATION UNDER ORC §709.021 AND §709.023

-2-

Thence Easterly, with the north line of said Parcel 5, about 1986 feet to the west right-of-way line for Taylor Station Road, the same being an existing City of Gahanna Corporation Line as established by Case No. 01-04, Ord. No. 0146-04, Instrument Number 200407280174371;

Thence Southwesterly, with said west right-of-way line, the same being said existing corporation line, about 66 feet to a south line of said Parcel 5;

Thence Westerly, with said south line, about 1259 feet to a corner thereof;

Thence Southerly, with an east line of said Parcel 5, about 484 feet to a corner thereof, in the south line of said Lot 26 and said existing City of Gahanna Corporation Line as established by Case No. GAH No. 8, Ord. No. 4-59, Misc. Record 115, Page 251;

Thence Westerly, with a south line of said Parcel 5, the same being the south line of said Lot 26 and said existing corporation line, about 1213 feet to the Point of Beginning. Containing approximately 27.9 acres of land, more or less. The above description was prepared by Advanced Civil Design, Inc. in April of 2008. An exhibit of the above description has been prepared and is made a part hereof.

The total length of the annexation perimeter is 9383 feet, of which 4613 feet are contiguous with the existing City of Gahanna Corporation Line, being 49% contiguous. No islands of township property are created by this annexation.

This description was written for annexation purposes only and was not intended to be used in the transfer of land.

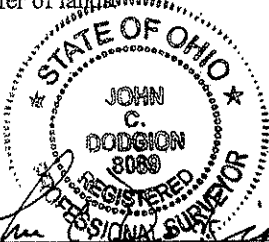

John C. Dodgion, P.S. 8089

Date:

05/12/2008

ADVANCED CIVIL DESIGN, INC.

ANNEXATION
PLAT & DESCRIPTION
ACCEPTABLE
DEAN C. RINGLE, PE., P.S.
FRANKLIN COUNTY ENGINEER

By B.B. Ringle Date 5/12/08