

AMENDMENT TO GROUND LEASE

From the City of Gahanna (lessor) to the Young Men's Christian Association of Central Ohio (lessee) as originally authorized by Gahanna City Ordinance 0268-2001.

Whereas, it is of mutual benefit to the City of Gahanna and to the Young Men's Christian Association of Central Ohio to add a parcel of property adjoining the existing lease property located at 4427 East Johnstown Road (more fully described in attachment "A").

The property that is subject to the ground lease is hereby increased by mutual agreement of the lessor and the lessee to include the 0.254 acre parcel as described on Attachment "A" with the same terms and provisions as the original lease area.

The lessor agrees to purchase the additional lease property and to remove the existing structures from the said property and provide the property to the lessee free of any environmental issues, graded and seeded in a mowable condition.

IN WITNESS WHEREOF, the parties have caused this lease to be signed by their proper corporate officers effective (date) _____

LESSOR

The City of Gahanna

By: _____ its: Mayor as authorized by ordinance _____

LESSEE

The Young Men's Christian Association of Central Ohio, an Ohio not-for-profit corporation

By: _____ its: _____

STATE OF OHIO :

COUNTY OF FRANKLIN:

The foregoing instrument was acknowledged before me this _____ day of _____ 2011

By _____, Mayor of the City of Gahanna, Ohio, a municipal corporation.

Notary Public. My Commission expires _____

STATE OF OHIO :

COUNTY OF FRANKLIN:

The foregoing instrument was acknowledged before me this _____ day of _____ 2011

By _____, of the Young Men's Christian Association of Central Ohio

Notary Public. My Commission expires _____



City of Gahanna Internet Mapping Site

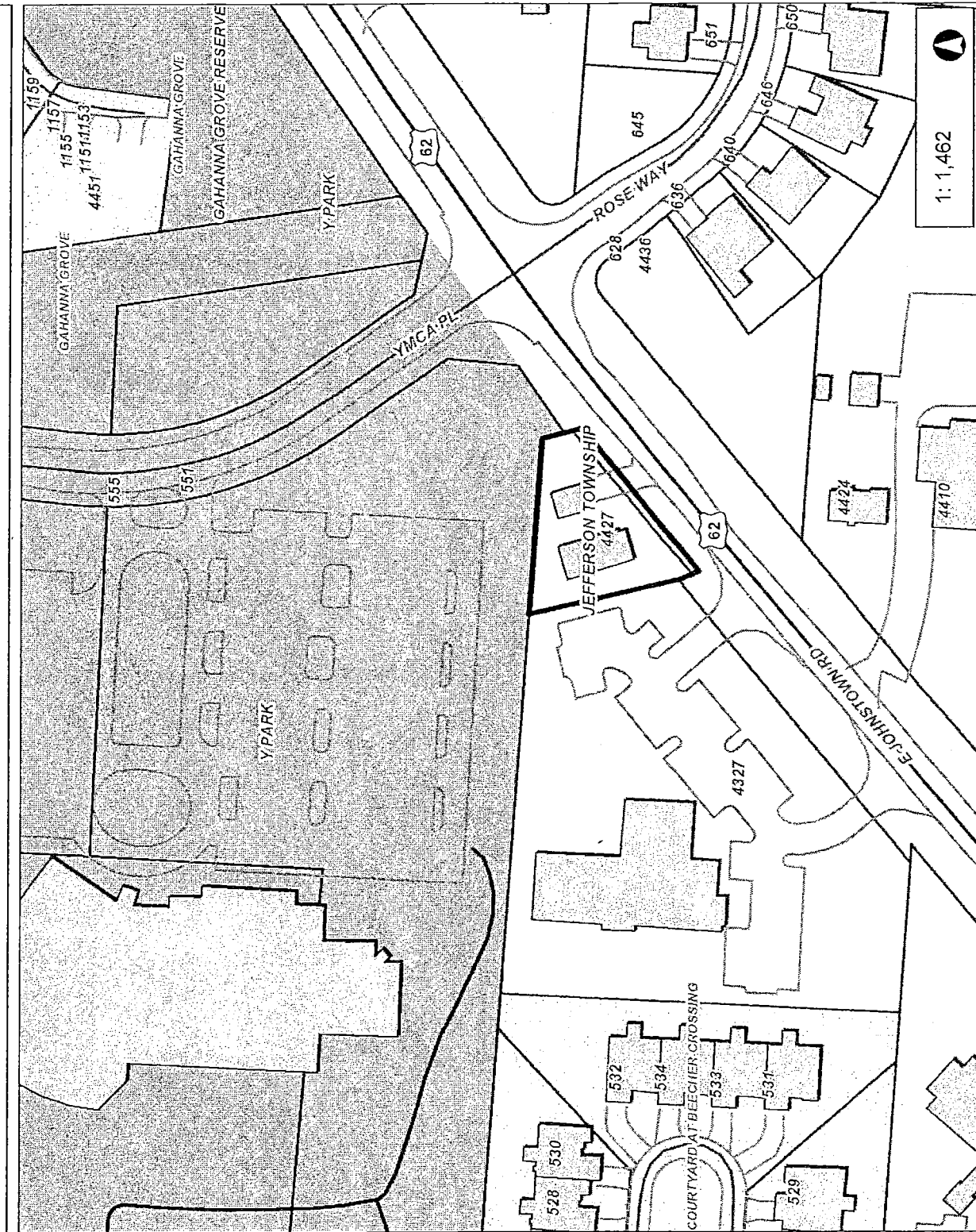

- Legend**
- Buildings
 - Roadways
 - Parcels
 - Parks

Notes

This map is a user generated static output from an Internet mapping site and is for reference only. Data layers that appear on this map may or may not be accurate, current, or otherwise reliable.

THIS MAP IS NOT TO BE USED FOR NAVIGATION

NAD_1983_StatePlane_Ohio_South_FIPS_3402_Feet

© City of Gahanna