

Scale: 1" = 20'

landfocus
CONSULTING
LANDFOCUSCONSULTING.COM
P.O. Box 677, Pendleton, IN 46064
info@landfocusconsulting.com
W: 855.776.8546 F: 765.776.8591

Client
King Avenue 1.0 LLC
10531 Timberwood Circle, Suite D
Louisville, Kentucky 40223
Tel: 502.425.1525

Date 08.29.2016

Revision
11.01.2016 Revised per comments from CoC/R/Photos per letter dated October 2, 2016.
11.30.2016 Revised per comments from CoC/R/Photos per letter dated November 25, 2016.
11.30.2016 (000T refers to the Ohio Department of Transportation)

Date 11.01.2016
11.30.2016

Project
FMC Medical Clinic
Gahanna (#23996-1)
4251 Johnstown Road, Winton Twp, Franklin County, Gahanna, Ohio
Site Location Plan



Sheet No.
C201
13 Civil Sheets

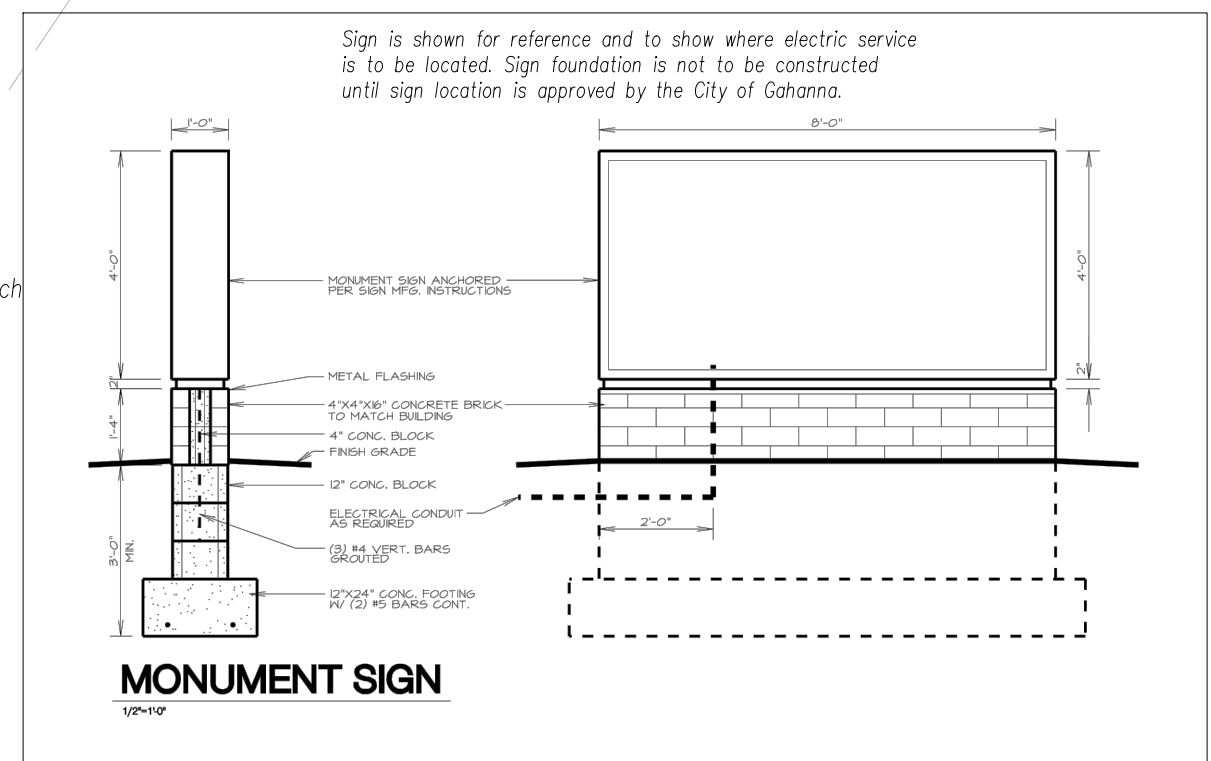
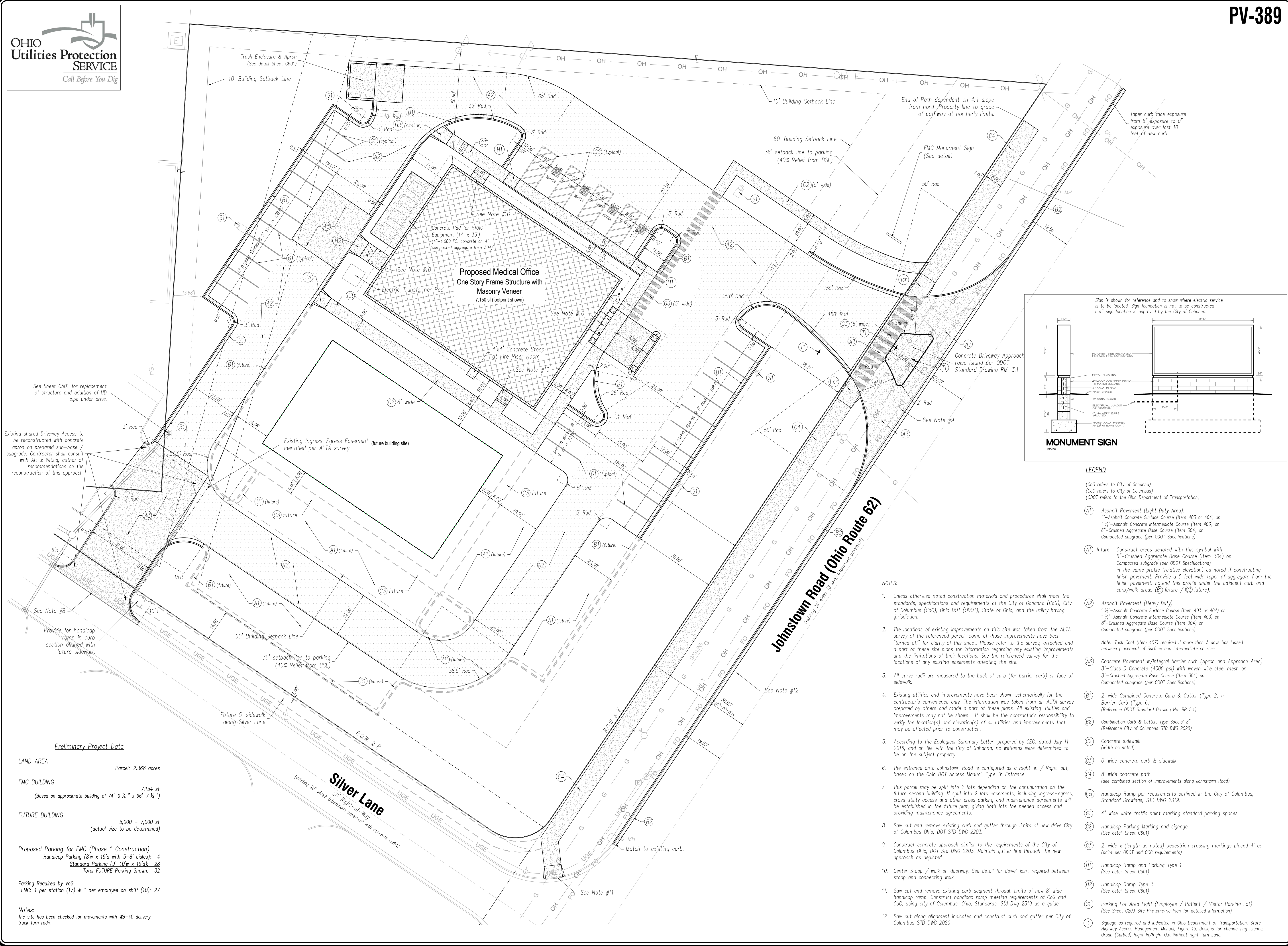

LEGEND
(CoC refers to City of Gahanna)
(CoC refers to City of Columbus)
(000T refers to the Ohio Department of Transportation)

- (A1) Asphalt Pavement (Light Duty Area):
1" - Asphalt Concrete Surface Course (Item 403 or 404) on
1 1/2" - Asphalt Concrete Intermediate Course (Item 403) on
6" - Crushed Aggregate Base Course (Item 304) on
Compacted subgrade (per 000T Specifications)
- (A1) future Construct areas denoted with this symbol with
6" - Crushed Aggregate Base Course (Item 304) on
Compacted subgrade (per 000T Specifications)
in the same profile (relative elevation) as noted if constructing
finish pavement. Provide a 5 feet wide taper of aggregate from the
finish pavement. Extend this profile under the adjacent curb and
curb/walk areas (B1) future / (C3) future.
- (A2) Asphalt Pavement (Heavy Duty)
1 1/2" - Asphalt Concrete Surface Course (Item 403 or 404) on
1 1/2" - Asphalt Concrete Intermediate Course (Item 403) on
8" - Crushed Aggregate Base Course (Item 304) on
Compacted subgrade (per 000T Specifications)
- (A3) Concrete Pavement w/Integral barrier curb (Apron and Approach Area):
8" - Class D Concrete (4000 psi) with woven wire steel mesh on
8" - Crushed Aggregate Base Course (Item 304) on
Compacted subgrade (per 000T Specifications)
- (B1) 2' wide Combined Concrete Curb & Gutter (Type 2) or
Barrier Curb (Type 6)
(Reference 000T Standard Drawing No. BP 5.1)
- (B2) Combination Curb & Gutter, Type Special 8"
(Reference City of Columbus STD DWG 2020)
- (C1) Concrete sidewalk
(width as noted)
- (C2) 6' wide concrete curb & sidewalk
- (C3) 8' wide concrete path
(see combined section of improvements along Johnstown Road)
- (C4) Handicap Ramp per requirements outlined in the City of Columbus,
Standard Drawings, STD DWG 2319.
- (C5) 4" wide white traffic paint marking standard parking spaces
(See detail Sheet C601)
- (C6) Handicap Parking Marking and signage.
(See detail Sheet C601)
- (C7) 2' wide x (length as noted) pedestrian crossing markings placed 4' oc
(point per 000T and CoC requirements)
- (H1) Handicap Ramp and Parking Type 1
(See detail Sheet C601)
- (H2) Handicap Ramp Type 3
(See detail Sheet C601)
- (S1) Parking Lot Area Light (Employee / Patient / Visitor Parking Lot)
(See Sheet C203 Site Photometric Plan for detailed information)
- (T1) Signage as required and indicated in Ohio Department of Transportation, State
Highway Access Management Manual, Figure 1b, Designs for channelizing islands,
Urban (Curbed) Right In/Right Out without Right Turn Lane.

- NOTES:**
1. Unless otherwise noted construction materials and procedures shall meet the standards, specifications and requirements of the City of Gahanna (CoG), City of Columbus (CoC), Ohio DOT (000T), State of Ohio, and the utility having jurisdiction.
 2. The locations of existing improvements on this site was taken from the ALTA survey of the referenced parcel. Some of those improvements have been "turned off" for clarity of this sheet. Please refer to the survey, attached and a part of these plans for information regarding any existing improvements and the limitations of their locations. See the referenced survey for the locations of any existing easements affecting the site.
 3. All curve radii are measured to the back of curb (for barrier curb) or face of sidewalk.
 4. Existing utilities and improvements have been shown schematically for the contractor's convenience only. The information was taken from an ALTA survey prepared by others and made a part of these plans. All existing utilities and improvements may not be shown. It shall be the contractor's responsibility to verify the location(s) and elevation(s) of all utilities and improvements that may be affected prior to construction.
 5. According to the Ecological Summary Letter, prepared by CEC, dated July 11, 2016, and on file with the City of Gahanna, no wetlands were determined to be on the subject property.
 6. The entrance onto Johnstown Road is configured as a Right-in / Right-out, based on the Ohio DOT Access Manual, Type 1b Entrance.
 7. This parcel may be split into 2 lots depending on the configuration on the future second building. If split into 2 lots easements, including ingress-egress, cross utility access and other cross parking and maintenance agreements will be established in the future plat, giving both lots the needed access and providing maintenance agreements.
 8. Saw cut and remove existing curb and gutter through limits of new drive City of Columbus Ohio, DOT STD DWG 2203.
 9. Construct concrete approach similar to the requirements of the City of Columbus Ohio, DOT Std DWG 2203. Maintain gutter line through the new approach as depicted.
 10. Center Stoop / walk on doorway. See detail for dowel joint required between stoop and connecting walk.
 11. Saw cut and remove existing curb segment through limits of new 8' wide handicap ramp. Construct handicap ramp meeting requirements of CoC and CoC, along city of Columbus, Ohio, Standards, Std Dwg 2319 as a guide.
 12. Saw cut, using alignment indicated and construct curb and gutter per City of Columbus STD DWG 2020

Preliminary Project Data

LAND AREA Parcel: 2.368 acres

FMC BUILDING 7,154 sf
(Based on approximate building of 74'-0 1/4" x 96'-7 1/4")

FUTURE BUILDING 5,000 - 7,000 sf
(actual size to be determined)

Proposed Parking for FMC (Phase 1 Construction)
Handicap Parking (8'w x 13'd with 5'-8" aisles): 4
Standard Parking (9'-10'w x 19'd): 28
Total FUTURE Parking Shown: 32

Parking Required by VoG
FMC: 1 per station (17) & 1 per employee on shift (10): 27

Notes:
The site has been checked for movements with WB-40 delivery truck turn radii.