

MORSE ROAD
(R/W VARIES)

RECEIVED
DEC 02 2022
BY: J. Van Meter
Clerk

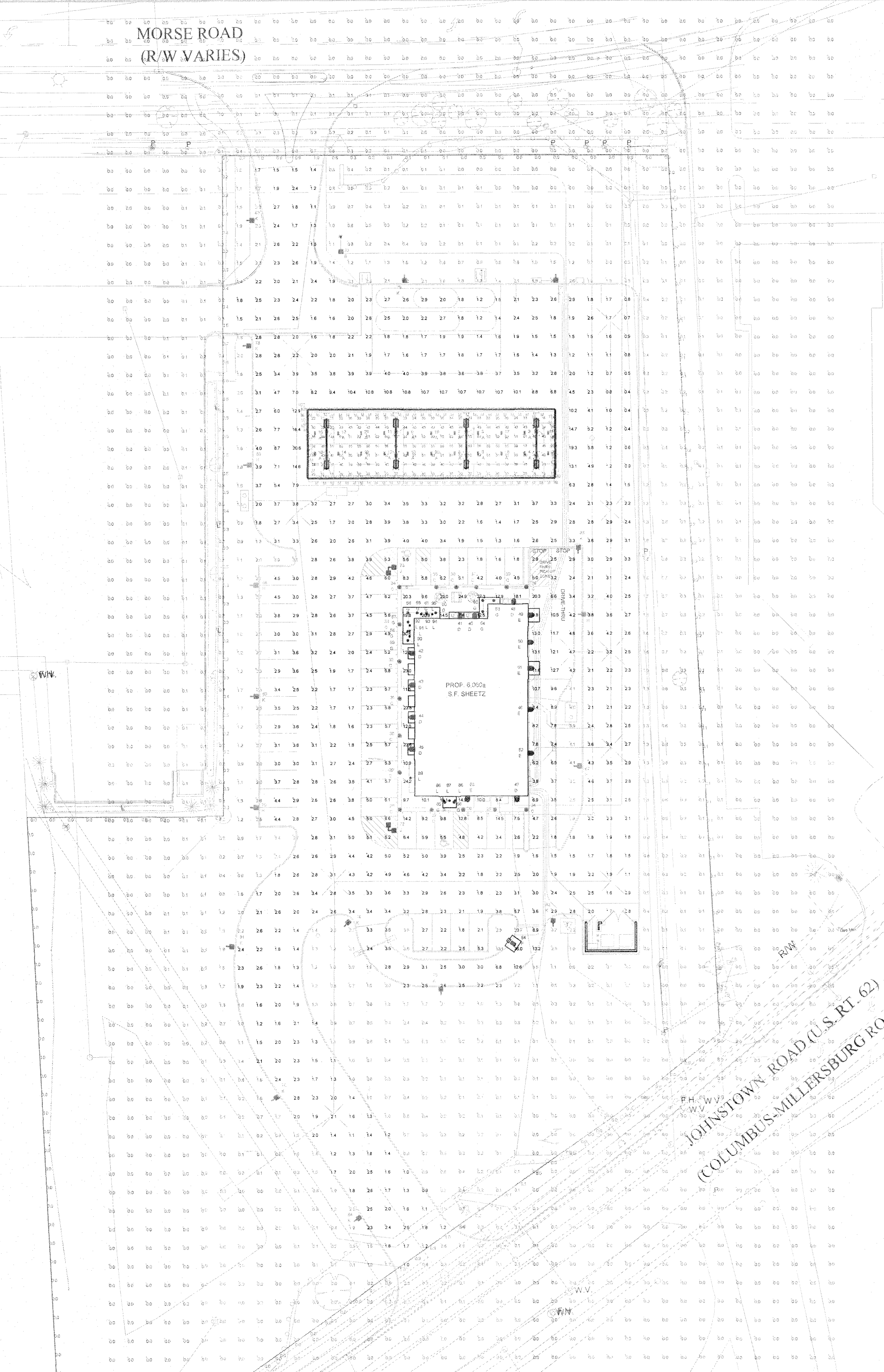

LUM. NO.	LABEL	MTG. HT.	TILT
1	A	18.79	-5
2	A	17.83	-5
3	A	18.79	-5
4	A	17.83	-5
5	A	18.79	-5
6	A	17.83	-5
7	A	18.79	-5
8	A	17.83	-5
9	A	18.79	-5
10	A	17.83	-5
11	A	18.79	-5
12	A	17.83	-5
13	A	18.79	-5
14	A	17.83	-5
15	A	18.79	-5
16	A	17.83	-5
17	A	18.79	-5
18	A	17.83	-5
19	A	18.79	-5
20	A	17.83	-5
21	A	18.79	-5
22	A	17.83	-5
23	B	1	168
24 - 39	C	3	0
40 - 45	D	12	0
46, 47	D	9.33	0
48	E	12	0
49	E	10	0
50	E	12	0

LUM. NO.	LABEL	MTG. HT.	TILT
51	E	10	0
52 - 53	E	12	0
54	F	11	0
55 - 66	G	11.33	0
67 - 71	H	23	0
72 - 73	J	23	0
74 - 85	K	23	0
86 - 95	L	18.5	30
96	M	18.77	5
97	M	19.123	5
98	M	19.476	5
99	M	19.83	5
100	M	20.183	5
101	M	20.537	5
102	M	20.89	5
103 - 134	M	21.079	0
135 - 167	M	17.887	0
168	M	21.079	0
169	M	18.062	5
170	M	18.415	5
171	M	18.77	5
172	M	19.123	5
173	M	19.476	5
174	M	19.83	5
175	M	20.183	5
176	M	20.537	5
177	M	20.89	5
178	M	18.062	5
179	M	18.415	5

NOTES:
- ALL AREA LIGHTS ON NEW 20 FT. POLE MOUNTED ON 3 FT. CONCRETE BASE

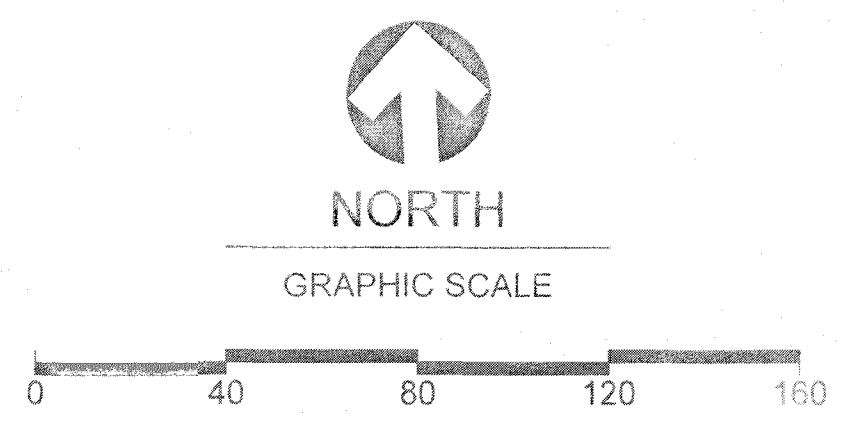

LABEL	AVG	MAX	MIN	AVG/MIN	MAX/MIN
PROPERTY LINES	0.15	1.0	0.0	N.A.	N.A.
SITE PAVED AREA	4.00	36.0	0.4	10.00	90.00
UNDEFINED	0.24	20.7	0.0	N.A.	N.A.
UNDER CANOPY	40.44	56	15	2.70	3.73

THIS SITE IS LOCATED IN A REGION WHERE LIGHTING IS REGULATED BY LOCAL ORDINANCES

SYMBOL	QTY	LABEL	ARRANGEMENT	LUMENS	LLF	BUG RATING	WATTS/LUMINAIRE	TOTAL WATTS	MANUFACTURER	CATALOG LOGIC
	22	A	SINGLE	11213	1.030	B3-U0-G0	71.28	1568.16	CREE, INC.	CAN-228-PS-RM-06-E-UL-XX-525-57K
	1	B	SINGLE	11950	1.040	B4-U0-G0	72	72	CREE, INC.	OSQ-ML-B-AA-XX + OSQM-B-11L-57K7-N3-UL-NM-XX
	16	C	SINGLE	1441	1.030	B1-U0-G1	22	352	CREE, INC.	PWY-EDG-3M-P3-02-E-UL-XX-350-57K
	8	D	SINGLE	2947	1.030	B1-U0-G1	36	288	CREE, INC.	SEC-EDG-3M-WM-02-E-UL-XX-525
	6	E	SINGLE	5893	1.030	B2-U0-G2	68	408	CREE, INC.	SEC-EDG-3M-WM-04-E-UL-XX-525
	1	F	SINGLE	13946	1.030	B3-U0-G1	132	132	CREE, INC.	BXCT9020&CAN-228-SL-RM-06-E-UL-XX-700 (BRIGHT RED FINISH, ORDERED SEPARATELY)
	12	G	SINGLE	484	1.000	N.A.	6.9	82.8	B-K LIGHTING, INC.	BKLT-CH-LED-669-FL-BZP-12 (BY OTHERS)
	5	H	SINGLE	8824	1.030	B1-U0-G2	72	360	CREE, INC.	OSQ-ML-B-DA-XX + OSQM-B-11L-57K7-3M-UL-NM-XX + OSQ-BLSMF
	2	J	2 @ 90 DEGREES	11174	1.030	B2-U0-G2	72	288	CREE, INC.	OSQ-ML-B-DA-XX + OSQM-B-11L-57K7-4M-UL-NM-XX
	12	K	SINGLE	8574	1.030	B1-U0-G2	72	864	CREE, INC.	OSQ-ML-B-DA-XX + OSQM-B-11L-57K7-4M-UL-NM-XX + OSQ-BLSMF
	10	L	SINGLE	626	1.000	B0-U1-G1	13.841	138.41	TROY-CSL LIGHTING	RA8-LED1140-XX-3 + 3SL23XX
	84	M	SINGLE	136	1.000	N.A.	4.12	346.08	BLAIR COMPANIES	4 FT. LINEAR STRIP LIGHT (BY OTHERS, SHOWN FOR CONTRIBUTION)

DISCLAIMER

ANY SITE PLANS, FLOOR PLANS, RENDERINGS, LIGHTING LAYOUT(S) AND PHOTOMETRIC PLAN(S) INCLUDING BUT NOT LIMITED TO ANY PROJECT(S) CREATED/PRODUCED BY RED LEONARD ASSOCIATES INC., ARE ONLY INTENDED FOR ILLUSTRATION AND QUOTING PURPOSES ONLY. RED LEONARD ASSOCIATES HAS THE RIGHT TO USE THIRD-PARTY LASERS, SCANNERS, AND CAMERAS BUT ACTUAL PROJECT CONDITIONS, DIMENSIONS, AND ACCURACY OF MEASUREMENTS MAY DIFFER FROM THESE OR ANY PARAMETERS. RED LEONARD ASSOCIATES INC. ASSUMES NO LIABILITY FOR WHAT IS CREATED/PRODUCED IN THESE RECREATIONS. THIS INCLUDES BUT IS NOT LIMITED TO THE USE OF, INSTALLATION OF AND/OR INTEGRITY OF EXISTING BUILDING(S), SURROUNDING AREA FOR PRODUCT(S) SUCH AS EXISTING POLES, ANCHOR BOLTS, BASE(S), ARCHITECTURAL AND SIGNAGE STRUCTURE(S), LANDSCAPING PLAN(S), LIGHTING PLAN(S), FIXTURE SELECTION(S) AND PLACEMENT, MATERIAL(S), COLOR ACCURACY, TEXTURES, AND ANYTHING ATTRIBUTED TO PHOTO REALISM THAT IS CREATED. FURTHERMORE, RED LEONARD ASSOCIATES INC. DOES NOT ASSUME LIABILITY WHATSOEVER FOR ANY PURCHASES MADE BY CLIENT BEFORE, DURING, OR AT THE CONCLUSION OF THE PUBLISHED WORK. THE CUSTOMER, ITS RELATIVE AFFILIATES, AS WELL AS ANY OTHER PERSON(S) IN VIEWING OF THIS PRODUCT IS RESPONSIBLE FOR VERIFYING COMPLIANCE WITH ANY BUT NOT LIMITED TO ALL CODES, PERMITS, RESTRICTIONS, INSTRUCTIONS, PURCHASES, AND INSTALLATIONS OF OBJECTS VIEWED WITHIN THIS DOCUMENT(S) OR PROJECT(S). SYMBOLS ARE NOT DRAWN TO SCALE. SIZE IS FOR CLARITY PURPOSES ONLY. SIZES AND DIMENSIONS ARE APPROXIMATE. ACTUAL MEASUREMENTS MAY VARY. DRAWINGS ARE NOT INTENDED FOR ENGINEERING OR CONSTRUCTION USE. THIS DOCUMENT, ANY RED LEONARD DRAWING(S), OR PROJECT(S) IS NOT TO BE USED AND/OR INTENDED FOR ENGINEERING OR CONSTRUCTION PURPOSES, BUT FOR ILLUSTRATIVE PURPOSES ONLY. ANY LOCATIONS OF EMERGENCY LIGHTING SHOWN WERE PROVIDED BY OTHERS. RED LEONARD ASSOCIATES IS NOT RESPONSIBLE FOR INSUFFICIENT LIGHTING DURING AN EMERGENCY EVENT. ANY USE OF THIS DOCUMENTATION AND/OR OTHER ARTICLES PRODUCED BY RED LEONARD WITHOUT WRITTEN AUTHORIZATION FROM JAVIER L. LEONARD IS STRICTLY PROHIBITED.

SCALE: 1" = 40'
DWG SIZE: D

PROJECT NAME:
SHEETZ
GAHANNA, OH
DRAWING NUMBER:
RL-7843-S1-R1



1340 Kemper Meadow Dr. Forest Park, OH 45240
513-574-9500 | redleonard.com

REV.	BY	DATE	DESCRIPTION
R1	DAR	7/1/22	REVISED PER UPDATED BASE PLAN

QTY	LABEL	DESCRIPTION
22	A	CAN-228-PS-RM-06-E-UL-XX-625-57K

QTY	LABEL	DESCRIPTION
1	B	OSQ-ML-B-AA-XX + OSQM-B-11L-57K7-N3-UL-NM-XX
5	H	OSQ-ML-B-DA-XX + OSQM-B-11L-57K7-3M-UL-NM-XX + OSQ-BLSMF
2	J	OSQ-ML-B-DA-XX + OSQM-B-11L-57K7-4M-UL-NM-XX
12	K	OSQ-ML-B-DA-XX + OSQM-B-11L-57K7-4M-UL-NM-XX + OSQ-BLSMF

QTY	LABEL	DESCRIPTION
16	C	PWY-EDG-3M-P3-02-E-UL-XX-350-57K

QTY	LABEL	DESCRIPTION
8	D	SEC-EDG-3M-WM-02-E-UL-XX-575
6	E	SEC-EDG-3M-WM-04-E-UL-XX-575

QTY	LABEL	DESCRIPTION
10	L	RAB-LED140-XX-3 + 3SL23XX

228 Series™ LED Recessed Canopy Luminaire

Product Description
Slim, low-profile, easy-mounting from below or above the deck. Luminaire sides are rugged cast aluminum with high performance, clear aluminum heat sinks specifically designed for LED. Luminaire mounts directly to the canopy deck and is secured in place with compression hardware. Luminaire is designed for easy installation. Luminaire is designed for easy installation. Luminaire is designed for easy installation.

Performance Summary
• Rugged, low-profile, easy-mounting from below or above the deck.
• Available in 12 standard and 2 specialty finishes with optional coating.
• To protect finish in coastal environments (salt & C) to the finish.
• Three styles in paired glass white.
• Consult factory for custom finish options.

Ordering Information
Example: CAN-228-PS-RM-06-E-UL-XX-625-57K

OSQ Series OSQ™ LED Area/Flood Luminaire featuring Cree TrueWhite™ Technology - Medium & Large

Product Description
The OSQ™ Area/Flood luminaire is a wide area, low-profile, easy-mounting from below or above the deck. Luminaire is designed for easy installation. Luminaire is designed for easy installation. Luminaire is designed for easy installation.

Performance Summary
• Rugged, low-profile, easy-mounting from below or above the deck.
• Available in 12 standard and 2 specialty finishes with optional coating.
• To protect finish in coastal environments (salt & C) to the finish.
• Three styles in paired glass white.
• Consult factory for custom finish options.

Ordering Information
Example: OSQ-ML-B-AA-XX + OSQM-B-11L-57K7-N3-UL-NM-XX

Cree Edge™ Series LED Pathway Luminaire

Product Description
The Cree Edge™ LED pathway luminaire is a low-profile, easy-mounting from below or above the deck. Luminaire is designed for easy installation. Luminaire is designed for easy installation. Luminaire is designed for easy installation.

Performance Summary
• Rugged, low-profile, easy-mounting from below or above the deck.
• Available in 12 standard and 2 specialty finishes with optional coating.
• To protect finish in coastal environments (salt & C) to the finish.
• Three styles in paired glass white.
• Consult factory for custom finish options.

Ordering Information
Example: PWY-EDG-3M-P3-02-E-UL-XX-350-57K

Cree Edge® Series LED Security Wall Pack Luminaire

Product Description
The Cree Edge® LED security wall pack luminaire is a low-profile, easy-mounting from below or above the deck. Luminaire is designed for easy installation. Luminaire is designed for easy installation. Luminaire is designed for easy installation.

Performance Summary
• Rugged, low-profile, easy-mounting from below or above the deck.
• Available in 12 standard and 2 specialty finishes with optional coating.
• To protect finish in coastal environments (salt & C) to the finish.
• Three styles in paired glass white.
• Consult factory for custom finish options.

Ordering Information
Example: SEC-EDG-3M-WM-02-E-UL-XX-575

ANGLE REFLECTOR Aluminum Shade with Glass and Guard Options

Electrical
• 120V (127V available in some areas) and 277V available in some areas.
• Available in 12 standard and 2 specialty finishes with optional coating.
• To protect finish in coastal environments (salt & C) to the finish.
• Three styles in paired glass white.
• Consult factory for custom finish options.

Ordering Information
Example: RAB-LED140-XX-3 + 3SL23XX

Additional Fixture Info

Accessories
Field Finish: Upgrade from 60° to 90° beam spread. Upgrade from 60° to 90° beam spread. Upgrade from 60° to 90° beam spread.

Ordering Information
Example: CAN-228-PS-RM-06-E-UL-XX-625-57K

Additional Fixture Info

Accessories
Field Finish: Upgrade from 60° to 90° beam spread. Upgrade from 60° to 90° beam spread. Upgrade from 60° to 90° beam spread.

Ordering Information
Example: OSQ-ML-B-AA-XX + OSQM-B-11L-57K7-N3-UL-NM-XX

Additional Fixture Info

Accessories
Field Finish: Upgrade from 60° to 90° beam spread. Upgrade from 60° to 90° beam spread. Upgrade from 60° to 90° beam spread.

Ordering Information
Example: PWY-EDG-3M-P3-02-E-UL-XX-350-57K

Additional Fixture Info

Accessories
Field Finish: Upgrade from 60° to 90° beam spread. Upgrade from 60° to 90° beam spread. Upgrade from 60° to 90° beam spread.

Ordering Information
Example: SEC-EDG-3M-WM-02-E-UL-XX-575

Additional Fixture Info

Accessories
Field Finish: Upgrade from 60° to 90° beam spread. Upgrade from 60° to 90° beam spread. Upgrade from 60° to 90° beam spread.

Ordering Information
Example: RAB-LED140-XX-3 + 3SL23XX

228 Series™ LED Recessed Canopy Luminaire

Product Specifications
• Slim, low-profile, easy-mounting from below or above the deck.
• Luminaire sides are rugged cast aluminum with high performance, clear aluminum heat sinks specifically designed for LED.
• Luminaire mounts directly to the canopy deck and is secured in place with compression hardware.
• Luminaire is designed for easy installation. Luminaire is designed for easy installation. Luminaire is designed for easy installation.

Construction & Materials
• Luminaire is designed for easy installation. Luminaire is designed for easy installation. Luminaire is designed for easy installation.

Electrical Data

LED Count (W)	System Voltage (V)	System Power (W)	Total Current (A)
228	120	228	1.90
228	277	228	0.83

Weight
• Luminaire weight: 1.90 lbs (0.86 kg)
• Shipping weight: 2.20 lbs (1.00 kg)

Ordering Information
Example: CAN-228-PS-RM-06-E-UL-XX-625-57K

OSQ™ LED Area/Flood Luminaire featuring Cree TrueWhite™ Technology - Medium & Large

Product Specifications
• The OSQ™ Area/Flood luminaire is a wide area, low-profile, easy-mounting from below or above the deck.
• Luminaire is designed for easy installation. Luminaire is designed for easy installation. Luminaire is designed for easy installation.

Construction & Materials
• Luminaire is designed for easy installation. Luminaire is designed for easy installation. Luminaire is designed for easy installation.

Electrical Data

LED Count (W)	System Voltage (V)	System Power (W)	Total Current (A)
OSQ-ML-B-AA-XX	120	OSQ-ML-B-AA-XX	OSQ-ML-B-AA-XX

Weight
• Luminaire weight: OSQ-ML-B-AA-XX lbs (OSQ-ML-B-AA-XX kg)
• Shipping weight: OSQ-ML-B-AA-XX lbs (OSQ-ML-B-AA-XX kg)

Ordering Information
Example: OSQ-ML-B-AA-XX + OSQM-B-11L-57K7-N3-UL-NM-XX

Cree Edge™ LED Pathway Luminaire

Product Specifications
• The Cree Edge™ LED pathway luminaire is a low-profile, easy-mounting from below or above the deck.
• Luminaire is designed for easy installation. Luminaire is designed for easy installation. Luminaire is designed for easy installation.

Construction & Materials
• Luminaire is designed for easy installation. Luminaire is designed for easy installation. Luminaire is designed for easy installation.

Electrical Data

LED Count (W)	System Voltage (V)	System Power (W)	Total Current (A)
PWY-EDG-3M-P3-02	120	PWY-EDG-3M-P3-02	PWY-EDG-3M-P3-02

Weight
• Luminaire weight: PWY-EDG-3M-P3-02 lbs (PWY-EDG-3M-P3-02 kg)
• Shipping weight: PWY-EDG-3M-P3-02 lbs (PWY-EDG-3M-P3-02 kg)

Ordering Information
Example: PWY-EDG-3M-P3-02-E-UL-XX-350-57K

Cree Edge® LED Security Wall Pack Luminaire

Product Specifications
• The Cree Edge® LED security wall pack luminaire is a low-profile, easy-mounting from below or above the deck.
• Luminaire is designed for easy installation. Luminaire is designed for easy installation. Luminaire is designed for easy installation.

Construction & Materials
• Luminaire is designed for easy installation. Luminaire is designed for easy installation. Luminaire is designed for easy installation.

Electrical Data

LED Count (W)	System Voltage (V)	System Power (W)	Total Current (A)
SEC-EDG-3M-WM-02	120	SEC-EDG-3M-WM-02	SEC-EDG-3M-WM-02

Weight
• Luminaire weight: SEC-EDG-3M-WM-02 lbs (SEC-EDG-3M-WM-02 kg)
• Shipping weight: SEC-EDG-3M-WM-02 lbs (SEC-EDG-3M-WM-02 kg)

Ordering Information
Example: SEC-EDG-3M-WM-02-E-UL-XX-575

ANGLE REFLECTOR Aluminum Shade with Glass and Guard Options

Product Specifications
• Slim, low-profile, easy-mounting from below or above the deck.
• Luminaire sides are rugged cast aluminum with high performance, clear aluminum heat sinks specifically designed for LED.
• Luminaire mounts directly to the canopy deck and is secured in place with compression hardware.
• Luminaire is designed for easy installation. Luminaire is designed for easy installation. Luminaire is designed for easy installation.

Construction & Materials
• Luminaire is designed for easy installation. Luminaire is designed for easy installation. Luminaire is designed for easy installation.

Electrical Data

LED Count (W)	System Voltage (V)	System Power (W)	Total Current (A)
RAB-LED140-XX-3	120	RAB-LED140-XX-3	RAB-LED140-XX-3

Weight
• Luminaire weight: RAB-LED140-XX-3 lbs (RAB-LED140-XX-3 kg)
• Shipping weight: RAB-LED140-XX-3 lbs (RAB-LED140-XX-3 kg)

Ordering Information
Example: RAB-LED140-XX-3 + 3SL23XX

Additional Fixture Info

Accessories
Field Finish: Upgrade from 60° to 90° beam spread. Upgrade from 60° to 90° beam spread. Upgrade from 60° to 90° beam spread.

Ordering Information
Example: CAN-228-PS-RM-06-E-UL-XX-625-57K

Additional Fixture Info

Accessories
Field Finish: Upgrade from 60° to 90° beam spread. Upgrade from 60° to 90° beam spread. Upgrade from 60° to 90° beam spread.

Ordering Information
Example: OSQ-ML-B-AA-XX + OSQM-B-11L-57K7-N3-UL-NM-XX

Additional Fixture Info

Accessories
Field Finish: Upgrade from 60° to 90° beam spread. Upgrade from 60° to 90° beam spread. Upgrade from 60° to 90° beam spread.

Ordering Information
Example: PWY-EDG-3M-P3-02-E-UL-XX-350-57K

Additional Fixture Info

Accessories
Field Finish: Upgrade from 60° to 90° beam spread. Upgrade from 60° to 90° beam spread. Upgrade from 60° to 90° beam spread.

Ordering Information
Example: SEC-EDG-3M-WM-02-E-UL-XX-575

Additional Fixture Info

Accessories
Field Finish: Upgrade from 60° to 90° beam spread. Upgrade from 60° to 90° beam spread. Upgrade from 60° to 90° beam spread.

Ordering Information
Example: RAB-LED140-XX-3 + 3SL23XX

REDLEONARD ASSOCIATES
1340 Kemper Meadow Dr, Forest Park, OH 45640
513-574-9500 | redleonard.com

CREE LIGHTING
1800 West 20th Street, Erie, PA 16590-0001
Canada: 1-800-473-1234 | 1-800-473-1234

CREE LIGHTING
1800 West 20th Street, Erie, PA 16590-0001
Canada: 1-800-473-1234 | 1-800-473-1234

CREE LIGHTING
1800 West 20th Street, Erie, PA 16590-0001
Canada: 1-800-473-1234 | 1-800-473-1234

CREE LIGHTING
1800 West 20th Street, Erie, PA 16590-0001
Canada: 1-800-473-1234 | 1-800-473-1234

REDLEONARD ASSOCIATES
1340 Kemper Meadow Dr, Forest Park, OH 45640
513-574-9500 | redleonard.com

PROJECT NAME: SHEETZ GAHANNA, OH
DRAWING NUMBER: RL-7843-S1-R1

REDLEONARD ASSOCIATES
1340 Kemper Meadow Dr, Forest Park, OH 45640
513-574-9500 | redleonard.com

SHEETZ
MADE TO ORDER

ANY SITE PLANS, FLOOR PLANS, RENDERINGS, LIGHTING LAYOUTS AND PHOTOMETRIC PLANS INCLUDING BUT NOT LIMITED TO ANY PROJECTS CREATED/PRODUCED BY REDLEONARD ASSOCIATES INC. ARE ONLY INTENDED FOR ILLUSTRATION AND QUOTING PURPOSES ONLY. REDLEONARD ASSOCIATES HAS THE RIGHT TO USE THIRD PARTY LASERS, SCANNERS, AND CAMERAS BUT ACTUAL PROJECT CONDITIONS, DIMENSIONS, AND ACCURACY OF MEASUREMENTS MAY DIFFER FROM THESE OR ANY PARAMETERS. REDLEONARD ASSOCIATES INC. ASSUMES NO LIABILITY FOR WHAT IS CREATED/PRODUCED IN THESE RECREATIONS. THIS DOCUMENT IS NOT LIMITED TO THE USE OF, INSTALLATION OF, AND/OR INTEGRITY OF EXISTING BUILDINGS, SURROUNDING AREA FOR PRODUCTS SUCH AS EXISTING POLES, ANCHORS, BOLTS, BASES, ARCHITECTURAL, AND SIGNAGE STRUCTURES, LANDSCAPING PLANS, LIGHTING PLANS, FIXTURE SELECTIONS AND PLACEMENT, MATERIALS, COLOR ACCURACY, TEXTURES, AND ANYTHING ATTRIBUTED TO PHOTO REALISM THAT IS CREATED. FURTHERMORE, REDLEONARD ASSOCIATES INC. DOES NOT ASSUME LIABILITY WHATSOEVER FOR ANY PURCHASES MADE BY CLIENT BEFORE, DURING, OR AT THE CONCLUSION OF THE PROJECT, THE CUSTOMER'S RELATIVE RESPONSIBILITIES, AS WELL AS ANY OTHER PERSONS IN VIEWING OF THIS PRODUCT IS RESPONSIBLE FOR VERIFYING COMPLIANCE WITH ANY BUT NOT LIMITED TO ALL CODES, PERMITS, RESTRICTIONS, INSTRUCTIONS, PURCHASES, AND INSTALLATIONS OF OBJECTS VIEWED WITHIN THIS DOCUMENT(S) OR PROJECT(S). SYMBOLS ARE NOT DRAWN TO SCALE. SIZE IS FOR CLARITY PURPOSES ONLY. SIZES AND DIMENSIONS ARE APPROXIMATE. ACTUAL MEASUREMENTS MAY VARY. DRAWINGS ARE NOT INTENDED FOR ENGINEERING OR CONSTRUCTION USE. THIS DOCUMENT, ANY RED LEONARD DRAWINGS, OR PRODUCTS IS NOT TO BE USED AND/OR REFERRED TO FOR ENGINEERING OR CONSTRUCTION PURPOSES, BUT FOR ILLUSTRATIVE PURPOSES ONLY. ANY USE OF THIS DOCUMENTATION AND/OR OTHER ARTICLES PRODUCED BY REDLEONARD WITHOUT WRITTEN AUTHORIZATION FROM JAMES J. LEONARD IS STRICTLY PROHIBITED.

