

CANDIDATE PROJECT TYPES (CONTINUED)

BICYCLE PEDESTRIAN PROJECTS

Addition of a multi-use trail, bicycle lane, sidewalk, or other facility for bicycle or pedestrian use.



TRANSIT PROJECTS

New or improved transit service such as bus, bus rapid transit, or rail.



Note that most arterial roadway projects will also incorporate infrastructure to accommodate all users, where appropriate, consistent with the Complete Streets concept: Complete Streets are roadways designed to safely and comfortably accommodate people of all ages and abilities, including but not limited to motorists, cyclists, pedestrians, transit and school bus riders, delivery and service personnel, freight haulers, and emergency responders.

FOR MORE INFORMATION OR TO SIGN UP FOR UPDATES ON THE MTP, VISIT morpc.org/mtp2040.

WHAT'S NEXT?

Help us identify transportation needs! Do you have a project suggestion?

VISIT morpc.org/mtp2040 to add your suggested projects and provide comments on the current candidate project list. Provide your input by August 31.

CONNECT WITH US:

facebook.com/morpc

twitter.com/morpc



**Mid-Ohio Regional
Planning Commission**

111 Liberty Street, Suite 100
Columbus, Ohio 43215

T 614.228.2663

www.morpc.org



METROPOLITAN TRANSPORTATION PLAN DEVELOPMENT PROCESS

The Metropolitan Transportation Plan (MTP) is a long-range planning document that brings together local governments from around Central Ohio and other local, state, and federal agencies to identify and coordinate transportation goals and policies over the next two decades. The MTP will identify transportation needs, strategies, and projects, and provide the basis for how federal transportation funding will be spent to improve highways, transit, freight, bikeways, and pedestrian facilities.

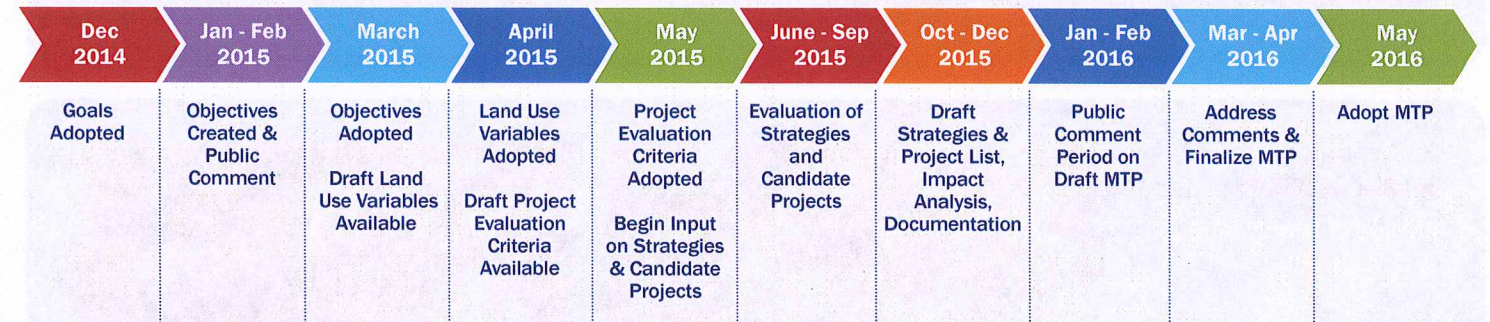

Work on the 2016-2040 MTP is underway. The goals of the plan were established in December 2014. Most recently, the project evaluation criteria were adopted in May 2015. Currently, candidate transportation projects are being compiled for evaluation and potential inclusion in the plan. More information on these milestones is available at www.morpc.org/mtp2040.

CANDIDATE PROJECT TYPES

The MORPC team is now identifying transportation needs and potential projects located within MORPC's transportation planning area shown in the map. This area includes Delaware and Franklin counties, Bloom and Violet townships in Fairfield County, New Albany, Pataskala and Etna Township in Licking County, and Jerome Township in Union County. The types of projects to be included in the plan are:

- New roadway or widening of a roadway
- Intersection improvement
- New or modified freeway interchange
- Other roadway projects such as roadway diet or access management
- Multi-use trail
- On-street bicycle facility
- New sidewalk
- New or improved transit service such as bus or rail

More information on next page.

Do you have a project suggestion?

Visit morpc.org/mtp2040 to add your suggested projects on our web map and provide comments on the current candidate project list.

MORPC Metropolitan Planning Organization Area

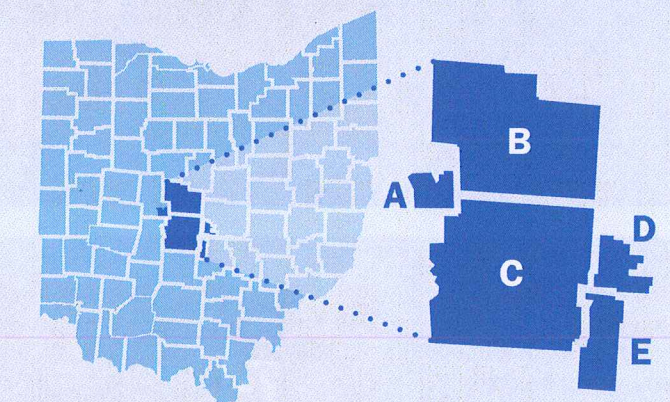

- | | |
|------------|-------------|
| A Union | D Licking |
| B Delaware | E Fairfield |
| C Franklin | |



MINOR WIDENING AND SAFETY IMPROVEMENTS OF ARTERIAL ROADWAYS

Addition of a center median and/or center turn lane or widening existing travel lanes to standard width.



BEFORE



AFTER

MAJOR WIDENING OF ARTERIAL ROADWAYS

Addition of travel lanes.

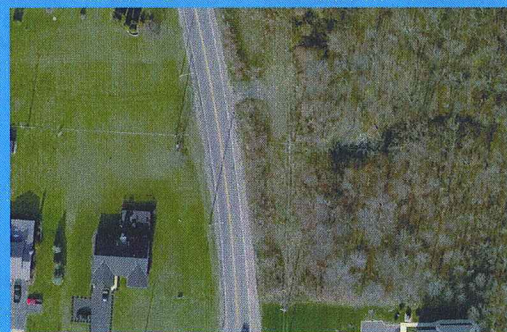

BEFORE

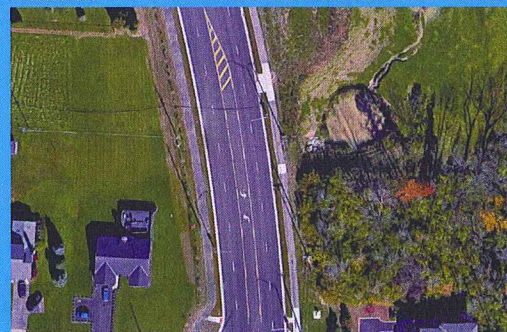

AFTER

INTERSECTION IMPROVEMENTS

Addition of turn lanes or other reconfiguration such as a roundabout.



BEFORE

AFTER



BEFORE

AFTER

ACCESS MANAGEMENT OF ROADWAYS

Limiting access points to and from a roadway by consolidating driveways and/or limiting turning movement options.



BEFORE



AFTER

ROADWAY DIET

Removal or width reduction of automobile travel lanes to accommodate transit, bicycle, and/or pedestrian facilities within a corridor.

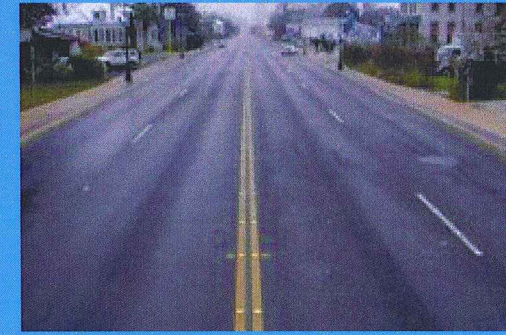

BEFORE



AFTER

MAJOR WIDENING OF FREEWAYS

Addition of travel lanes.



BEFORE



AFTER

NEW INTERCHANGES

Adding a grade-separated interchange where an at-grade intersection or no intersection existed previously.



BEFORE



AFTER

INTERCHANGE MODIFICATIONS

Modification of existing interchange to improve operations and accommodate additional capacity, widen an overpass, and/or modify ramp intersections.



BEFORE



AFTER