

# MORSE ROAD PROJECT

- \$50 Million Investment
- Gated & Fenced Community
- Green Stormwater Management Practices
  - Rain Gardens | Pervious Pavers | Reduced Amount of Curbing
- \$13,041,524 Non-School TIF Impact Over 30 Years  
\*Provided by the Economic Development Office City of Gahanna
- \$18,774,831 School Compensation Over 30 Years  
\*Provided by the Economic Development Office City of Gahanna

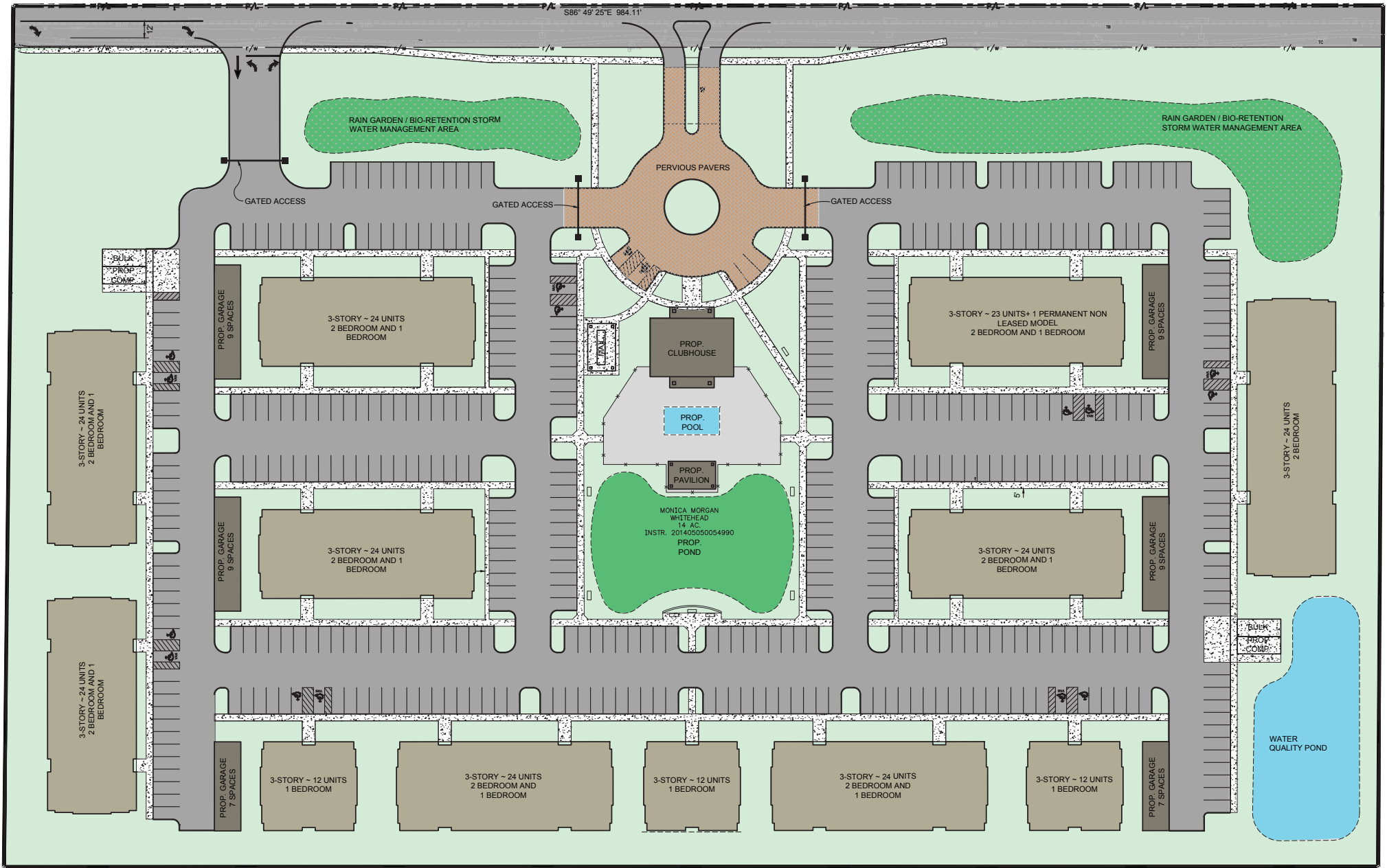

# MORSE ROAD





# THE PARC

• Opened in 2017

• 180 Class A Apartments

72 One-Bedroom | 92 Two-Bedroom | 16 Three-Bedroom

• Luxury Features & Amenities

Granite Countertops  
Stainless Steel Appliances  
Nine-Foot Ceilings  
Double Sink Bathrooms  
Oversized Windows  
Wood Style Flooring

Walk-In Closets  
Balcony or Patio  
Coffee Bar  
Elevator Access  
Fire Pit & Grilling Stations  
Smoke Free

Gated Community  
Clubhouse  
24-Hour Fitness Center  
Heated Saltwater Pool  
Pool Side Cabanas  
Business Center

• Total Real Estate Taxes Paid to Date

**\$3,404,890**

• Total Real Estate Taxes Paid to Gahanna-Jefferson Schools to Date

**\$2,009,226**

• Number of School Aged Children in Residence

**21**

# We are... The Stonehenge Company



But you might **know us** by other names



**BriHi Square**  
Dublin, OH



**The Golf Club at Little Turtle**  
Westerville, OH



**Turtle Parc**  
Westerville, OH

As one of central Ohio's leading builders and developers of luxury homes, condominiums, office spaces, and mixed-use developments, The Stonehenge Company recognizes what it takes to create, sustain, and elevate a space into a community and a home. Since our founding in 1987, our mission has been to build and develop attractive, sophisticated, luxury residential and commercial environments that meet the needs and desires of home and business owners, municipalities, and our neighbors. At The Stonehenge Company we are committed to more than just laying the simple brick and mortar of the buildings that compose the communities in which we work. Instead, we strive to capture and reflect the unique elements that define them, elevate them, and help them grow and flourish.

We take pride in our ability to efficiently and cost effectively deliver high-quality products, with an unsurpassed attention to detail. We hold ourselves and our vendors to the highest standards, and this high standard translates into our projects, which we not only build, but also manage and maintain from the very first brick being laid, to every resident or client that walks through our doors and call our properties home, all from our offices located right in the heart of Gahanna.



**Creekside**  
Gahanna, OH



**HighPointe**  
Westerville, OH



**The Pierce**  
Columbus, OH

*Building in our Communities*