

Wright-Patt Credit Union

1317 N Hamilton Rd

DR-22-2020

Location/Zoning Map

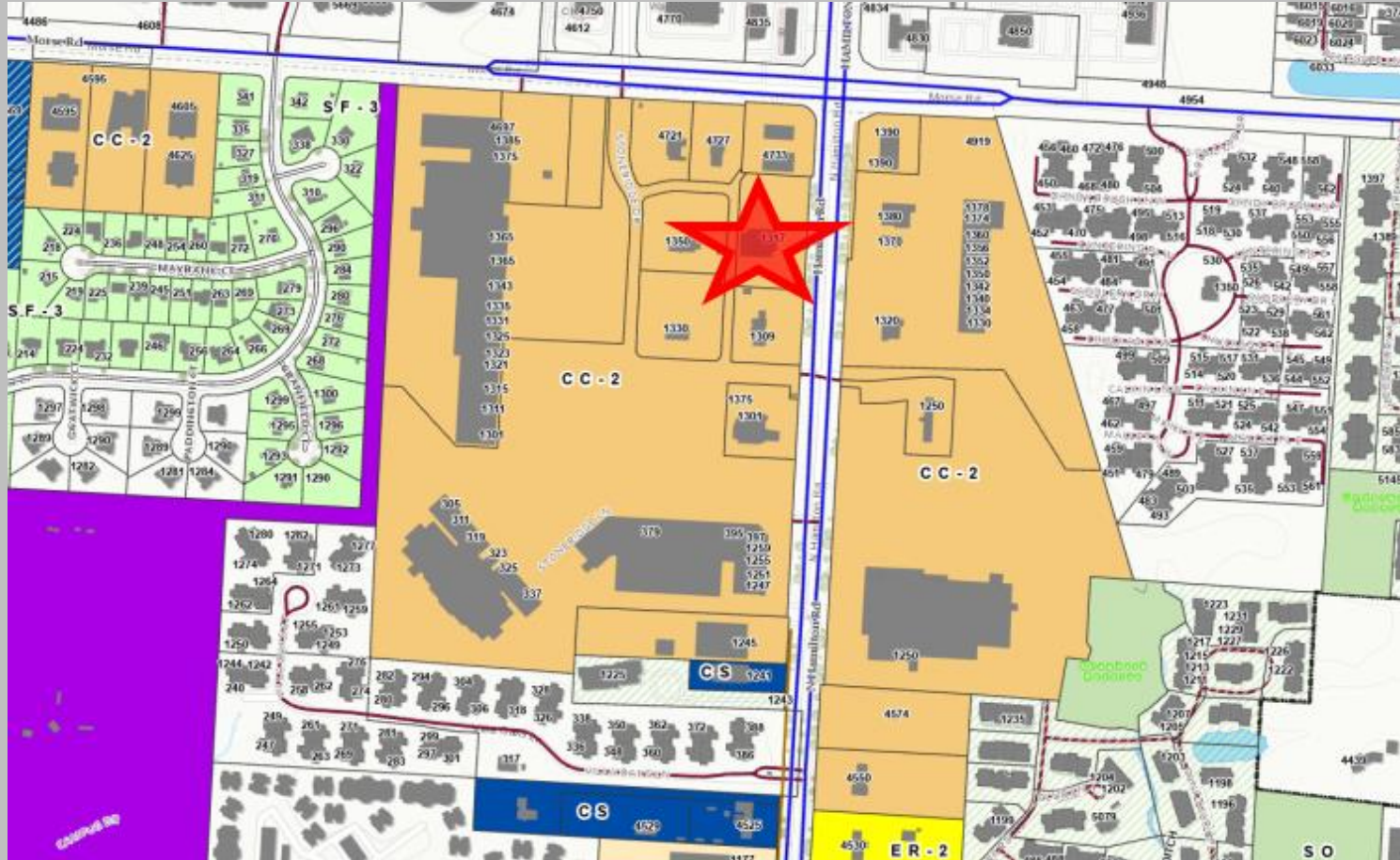

Summary

- Site of former Max and Ermas proposed to change to credit union
 - Wright-Patt
- Façade changes include
 - New color palette
 - New stone
 - New brick veneer
 - New roof
 - New canopy

Summary

- Parking layout revised to permit remote teller
- New lighting
- New landscaping
- Property zoned CC-2
 - Banks/credit unions allowed by right
- No variances

Site Plan

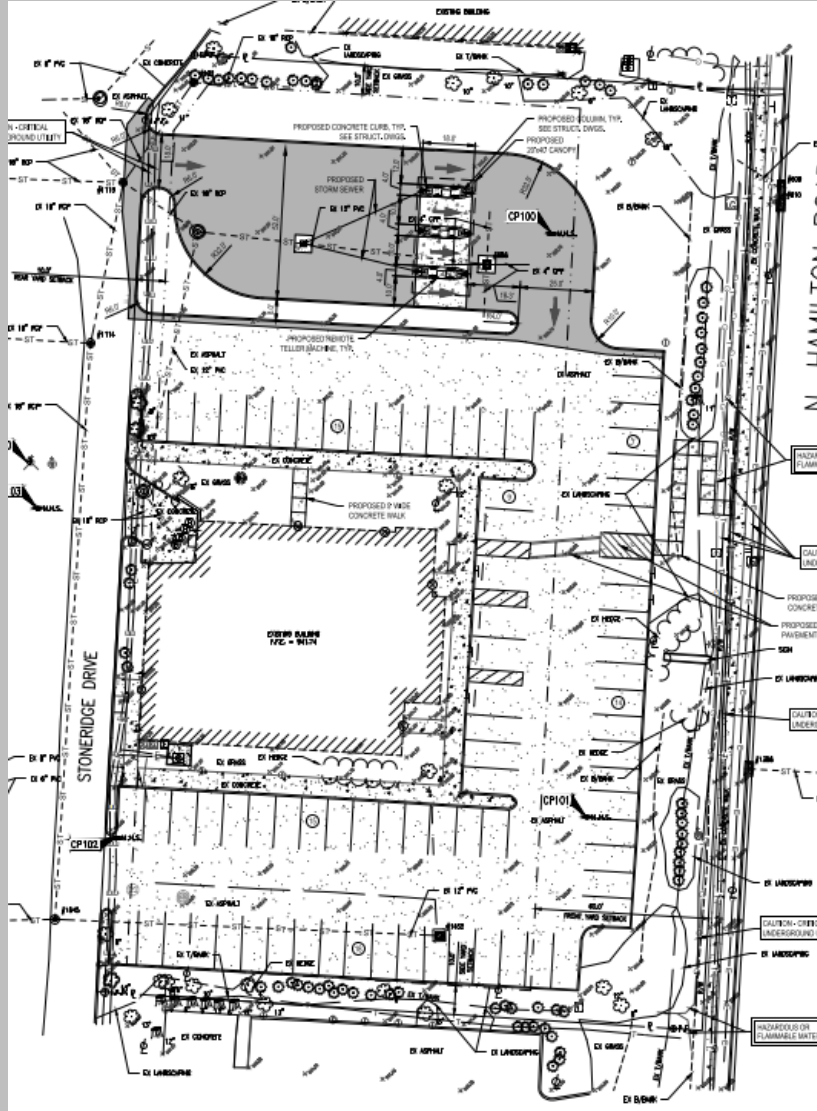



Gahanna

Where currents connect