

T&S Parcel

00/9/00

http://198.234.34.199/realestate/Detail_Transfer.asp?tab=transfer



Parcel ID 025-004245-00	Address 0 TAYLOR RD	Index Order Owner(Current)	Card 1 of 1
-----------------------------------	-------------------------------	--------------------------------------	-----------------------

Property Location TAYLOR RD	Sqft 0	Rooms	Full Baths
Tax Dist 025 CITY OF GAHANNA- GAHANNA JEF	Yr Blt	Bdrms	Half Baths
Sch Dist 2506			
Land Use 300 VACANT INDUSTRIAL LAND			

Owner Information SINGH LYNN W SINGH KANWAL N	Mailing Information SINGH LYNN W @(2) 2701 INDIANOLA AVE COLUMBUS OH 43202	Property Information 5799 TAYLOR ROAD R16 T1 1/4T3 LOT 25 26.375 ACRES 025-0039E -044-00
--	---	---

Board of Revision Yes	Valid Sale Yes	1999 Mkt Land Value \$800,700
Homestead No	# of Parcels 1	1999 Cauv Value \$0
2.5% Reduction No	Deed Type GW	1999 Mkt Impr Value \$0
Divided Property Yes	Sale Amount \$425,532	1999 Mkt Total Value \$800,700
New Construction No	Date 01/13/2000	
Foreclosure No	Conveyance 828	1999 Annual Taxes \$18,171.44
Other Assessments No	#	1999 Total Taxes \$18,171.44
Front Ft. 0.00	Deed Number	Due
	Acres 35.585	1999 Total Taxes Paid \$9,085.72

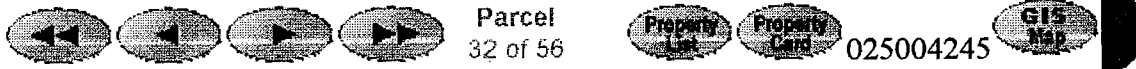

E-mail Joe Testa

Legal Disclaimer

This data is updated daily to close of business status, previous day.

Easment .972 ac

Legal Disclaimer

E-mail Joe Testa

Parcel ID 025-000243-00	Address 88 SHULL (R) AV	Index Order Address	Card 1 of 1
Deed Book Page Account #	Sale Price \$102,000	Sale Date 12/28/1999	Owner NUNGESSER JOHN A @ (2)
Transfer History	Validity of Sale	Parcel 1 of 1	GIS 025000243



T.&S. INDUSTRIAL

Situated in the State of Ohio, County of Franklin, City of Gahanna, being located in the Southwest Quarter of Township 1, Range 16, United States Military Lands and being two (2) strips of land (Strip 1 being 20 feet in width, and Strip 2 being 15 feet in width) across that tract of land conveyed to T.&S. Industrial by deed of record in Official Record 13182F19, all references being to records in the Recorder's Office, Franklin County, Ohio, the centerline of said strips being described as follows:

PERMANENT EASEMENTS
STRIP 1

Beginning at a point in the westerly line of said T.&S. Industrial tract, the easterly line of the Andre M. Buckles 220.064 acre tract, of record in Deed Book 3700, Page 120, said point being located North 3° 33' 45" East, 363.39 feet from the southeasterly corner of said 220.064 acre tract;

thence North 67° 29' 45" East, 13.36 feet to a point;

thence South 25° 31' 41" East, 50.07 feet to a point;

thence North 63° 55' 28" East, 353.19 feet to a point;

thence North 40° 34' 33" East, 226.42 feet to a point;

thence North 01° 39' 26" West, 194.36 feet to a point;

thence North 42° 18' 15" East, 370.30 feet to a point;

thence North 52° 34' 42" East, 209.42 feet to a point (herein referenced as Point "A");

thence South 53° 02' 05" East, 194.00 feet to a point;

thence North 81° 04' 12" East, 320.00 feet to the point of terminus in the easterly line of the T.&S. Industrial tract and the westerly line of that 5.431 acre tract conveyed to Arthur J. Emrick and Carol Jean Emrick by deeds of record in Deed Book 3507, Page 729, and Official Record 2262F05, said point bears South 4° 29' 09" West along said line, a distance of 465.00 feet from the centerline of Taylor Road;

TOGETHER WITH the right to use, only during the period of construction, two (2) additional strips of land, said strips being described as follows:

Continued.....

TEMPORARY CONSTRUCTION EASEMENTS
STRIP 1

Being a strip of land one hundred (100) feet in width, said strip to lie northerly from and adjacent to the above described Permanent Easement.

STRIP 2

Being a strip of land twenty-five (25) feet in width, said strip to lie southerly from and adjacent to the above described Permanent Easement.

PERMANENT EASEMENT
STRIP 2

Beginning for reference at Point "A" as described in Permanent Easement Strip 1;

thence North 33° 00' 11" East, a distance of 10.02 feet to a point in the northeasterly line of Strip 1 and being the true place of beginning for the following described line;

thence North 33° 00' 11" East, a distance of 97.97 feet to a point;

thence North 4° 03' 46" East, a distance of 297.05 feet to the point of terminus, said point being in the southerly lie of an existing 15 foot wide easement and bears South 4° 03' 46" East, a distance of 40.00 feet from the existing centerline of Taylor Road;

Together with the right to use, only during the period of construction, two additional strips of land described as follows:

TEMPORARY CONSTRUCTION EASEMENTS
STRIP 1-A

Being a strip of land 60.00 feet in width, said strip to lie westerly from and adjacent to the westerly line of Permanent Easement Strip 2.

STRIP 2-A

Being a strip of land 25.00 feet in width, said strip to lie westerly from and adjacent to the easterly line of Permanent Easement Strip 2.

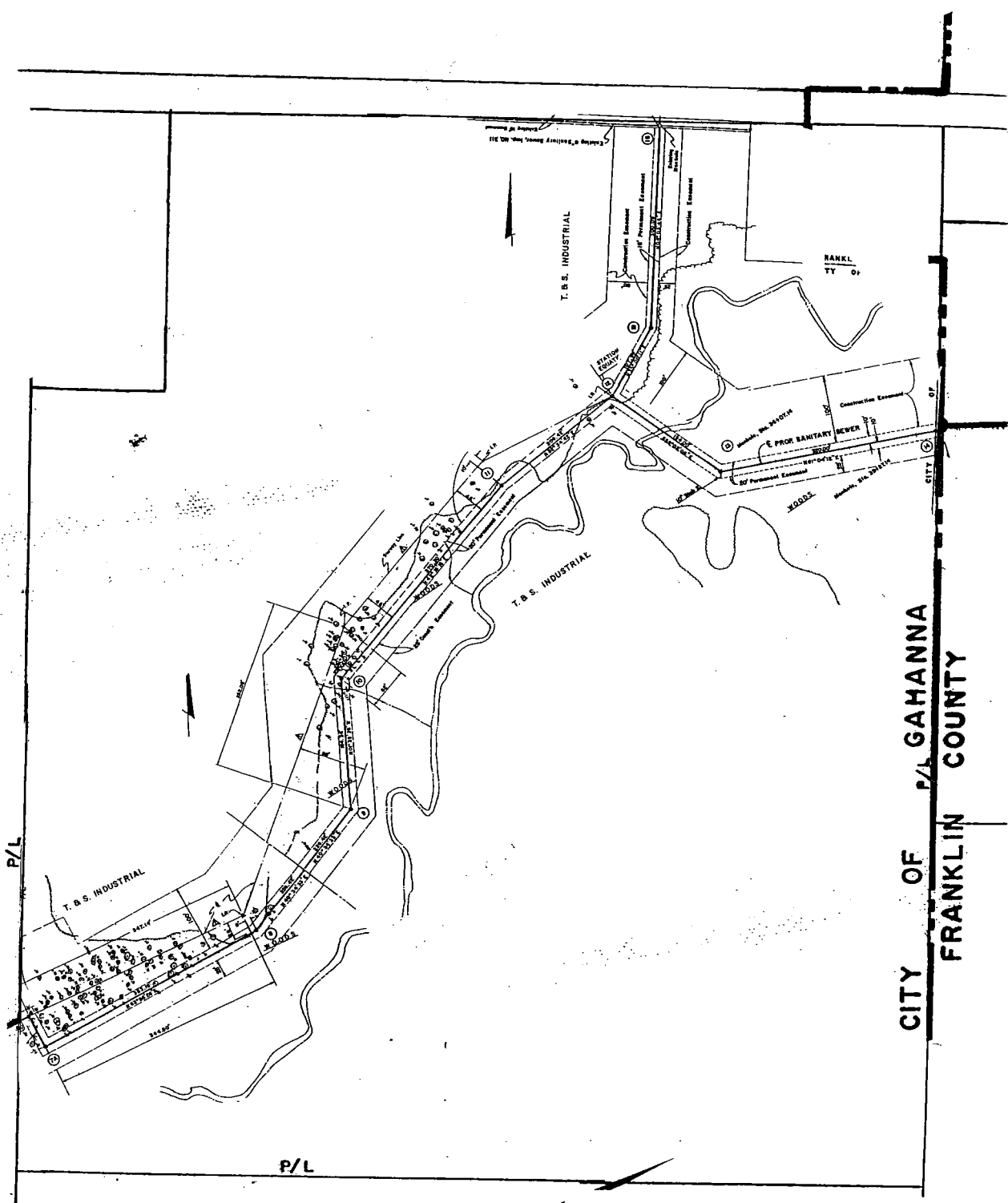

INDEX MAP
SCALE - 1" = 200'

CITY OF FRANKLIN COUNTY
P/L GAHANNA